

oakheart

£165,000

By Auction
Commercial Road, Lowestoft



Offered for immediate sale is this mixed use residential/commercial freehold building in the centre of Lowestoft. It hosts a wealth of opportunity for a new owner with plenty of potential on offer. We have reason to believe it may suit ideally as a HMO conversion, multiple flats or further retail/commercial rental investment. (stpp).

The property is ideally located within the heart of the proposed East Suffolk Council Masterplan, where a full regeneration project is being undertaken. Please see below link, taking you to the full proposed Masterplan.

<https://www.eastsuffolk.gov.uk/assets/Business/Regeneration-projects/Lowestoft-Town-Centre-Masterplan.pdf>

The property is centrally located on the doorstep of both Lowestoft's Railway Station, Town Centre and the South Pier.

Please call Oakheart Property to arrange an internal viewing by prior appointment only.









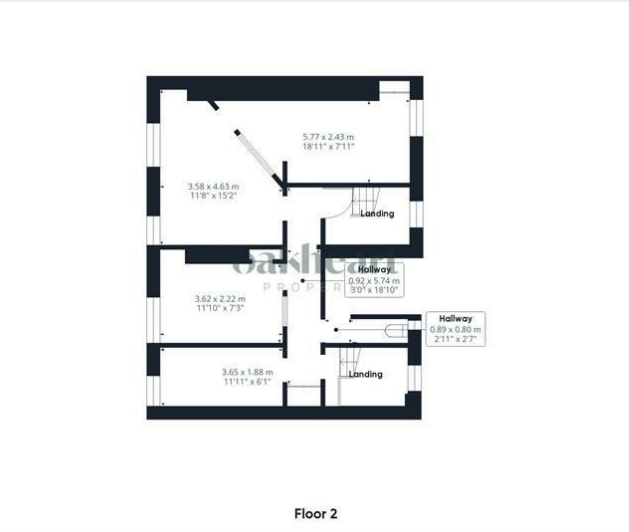
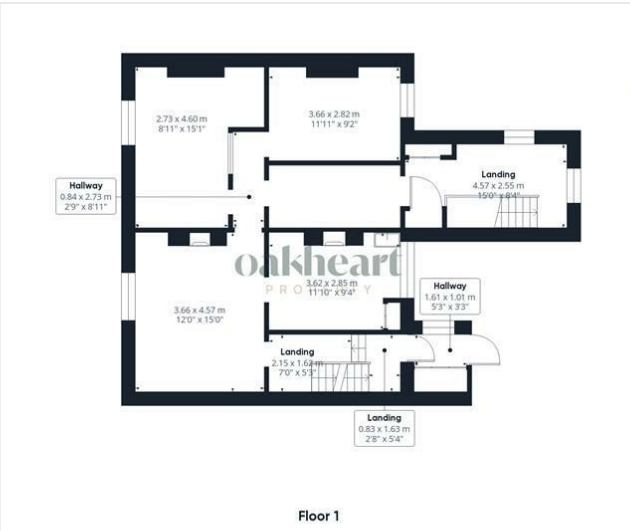
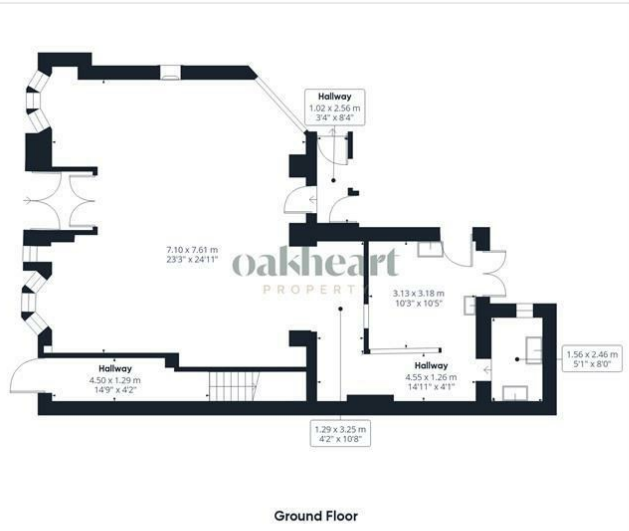

oakheart

Approximate total area⁽¹⁾
 213.63 m²
 2299.54 ft²

(1) Excluding balconies and terraces.

While every attempt has been made to ensure accuracy, all measurements are approximate, not to scale. This floor plan is for illustrative purposes only.

GIRAFFE360

Local Authority:
 East Suffolk Council

Tenure:
 Freehold

Council Tax Band:
 Exempt

Agents Note: Whilst every care has been taken to prepare these particulars, they are for guidance purposes only. All measurements are approximate and are for general guidance purposes only and whilst every care has been taken to ensure their accuracy, they should not be relied upon.