



Hampstead Lane, Maidstone, ME18

Offers Over £950,000





Sitting on its own island, a unique and wonderful opportunity to create multiple properties or a destination hospitality business in a fantastic location 0.75-acre plot



Key Features

- Sensational outdoor space
- Fantastic views
- 0.75-acre
- Over 370sq/m
- Commercial development
- Residential development
- Outstanding opportunity
- Idyllic location
- Riverside
- GDV £2m+









Commercial Development Land, Kent
Teapot Island, Yalding
Offer Over £950,000

□ Opportunity

This is a fantastic, unique opportunity to create a very special hospitality offering, be it a wedding venue, pub, restaurant, collection of holiday homes or one function venue

The location is second to none, surrounded by affluent villages, a year-round tourist destination on the River Medway

The property could also be converted into a very large grand house or up to five separate dwellings, subject to a successful change of use application, with a GDV over £2m



The substantial plot offers the opportunity, STPP, to build a separate house or holiday lodges in the garden – further adding to the GDV

□ Location

‘Teapot Island’ is on the fringe of Yalding, one of the most affluent and desirable villages in the area

One of the most sought-after villages in the area, properties regularly achieve £5,000 per square metre

Teapot Island is a sits just outside Yalding where the River Teise





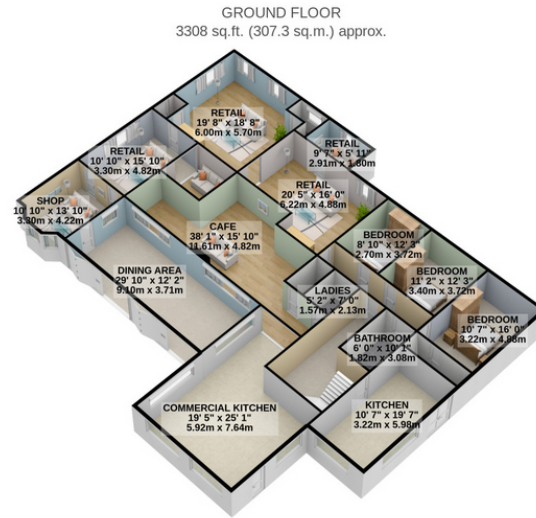

1ST FLOOR
781 sq.ft. (72.5 sq.m.) approx.



TOTAL FLOOR AREA : 4089 sq.ft. (379.9 sq.m.) approx.

For illustrative purposes only. Decorative finishes, fixtures, fittings and furnishings do not represent the current state of the property. Measurements are approximate. Not to scale.
 Made with Metropix © 2023



Tenure Type: Freehold
Council Tax Band:
Council Authority: