

Pizza Baby

21 Flemingate, Beverley HU17 0LL

Pizza Baby is a very busy, successful 'New York' style Italian restaurant in Flemingate Shopping Centre, Beverley, with 120 covers inside and 80 outside this is a superb business opportunity.



- Large Italian restaurant
- 200 covers
- Busy shopping centre
- Night time dining and drinking circuit
- Completely refurbished
- Turnover over £400,000 in six months
- Managed business
- Large covered outside seating area



CURRENT TRADING HOURS

Pizza Baby is open seven days a week from 10:00 until 23:00.

Local bars are currently open until as late as 02:00, additional revenue could be achieved by increasing the opening hours.

During the first lockdown Pizza Baby used a delivery service and generated sales in excess of £5,000 per week, reintroducing this could see sales increase even further.



SUMMARY

Pizza Baby is an ultra-modern New York style Italian restaurant in the busy shopping and food centre of Beverley. Flemingate is the shopping and social centre of Beverley day and night.

LOCATION

Pizza Baby is in the 'Flemingate Shopping Centre' which hosts of big-name stores and the Parkway Cinema, with a 500-space multi-storey car park.

Beverley is a beautiful historic town in Yorkshire, boasting a minster it attracts tourists throughout the year. The county town of East Yorkshire, Beverley is a vibrant and busy town with a large catchment area.



TENURE

Pizza baby is available to buy as a leasehold business, at offers over £175,000

The rent is £52,000 per annum including service costs.

We have been advised by our client that the landlord is willing to assign a new lease to the incoming party for a term to be agreed, the current lease has five years remaining.

TRADING INFORMATION

Full accounts are available upon request.

We have been advised by our client that the turnover from May to October was in excess of £400,000.



GROUND FLOOR

3319 sq.ft. (308.3 sq.m.) approx.

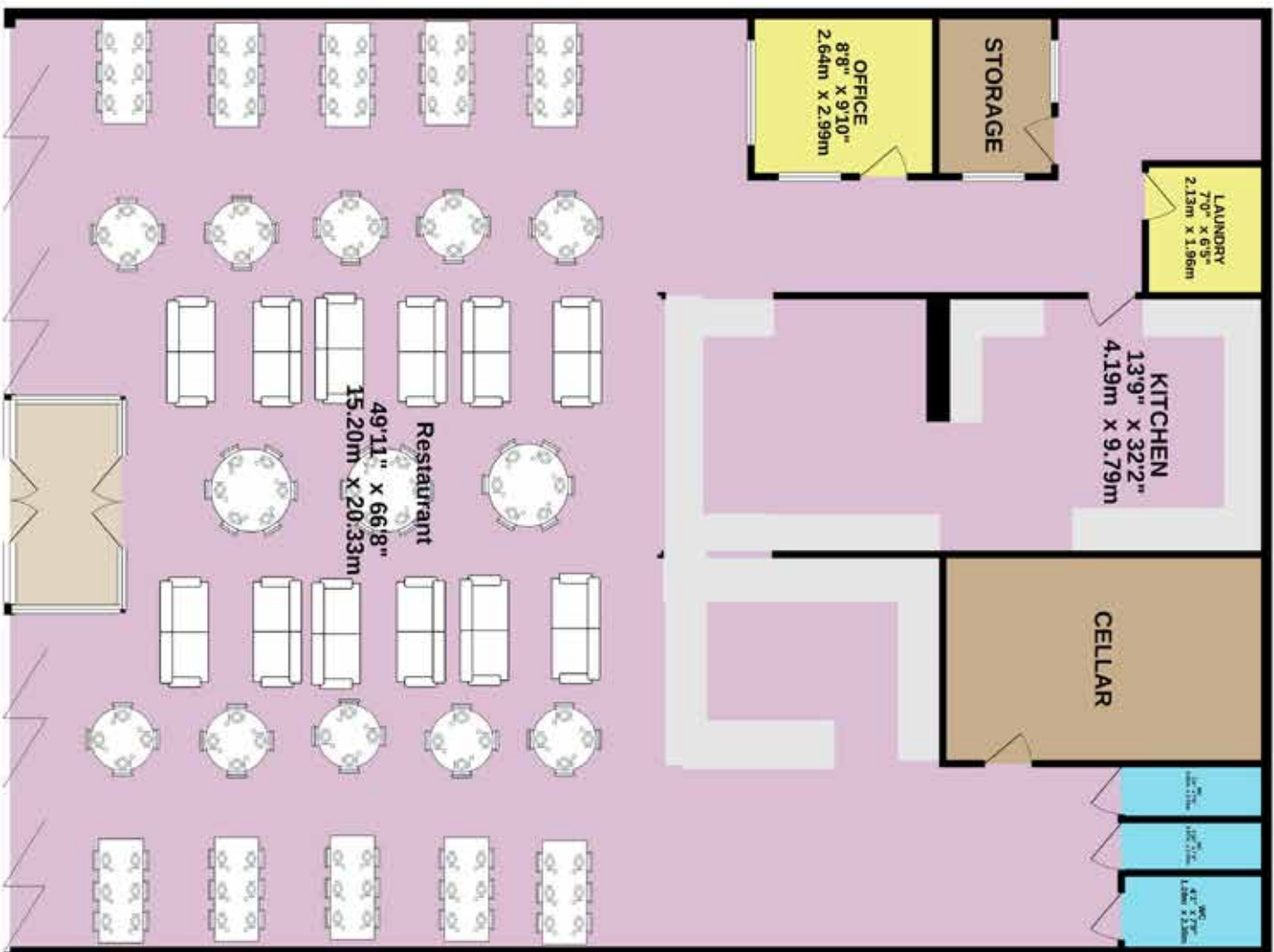

TOTAL FLOOR AREA : 3319 sq.ft. (308.3 sq.m.) approx.

Whilst every attempt has been made to ensure the accuracy of the floorplan contained here, measurements of doors, windows, rooms and any other items are approximate and no responsibility is taken for any errors or mis-statement. This plan is for illustrative purposes only and should not be used as such by any prospective purchaser. The services shown are not guaranteed and no guarantee can be given as to their operability or efficiency can be given.

Made with Metropix ©2023

GROUND FLOOR
3319 sq.ft. (308.3 sq.m.) approx.

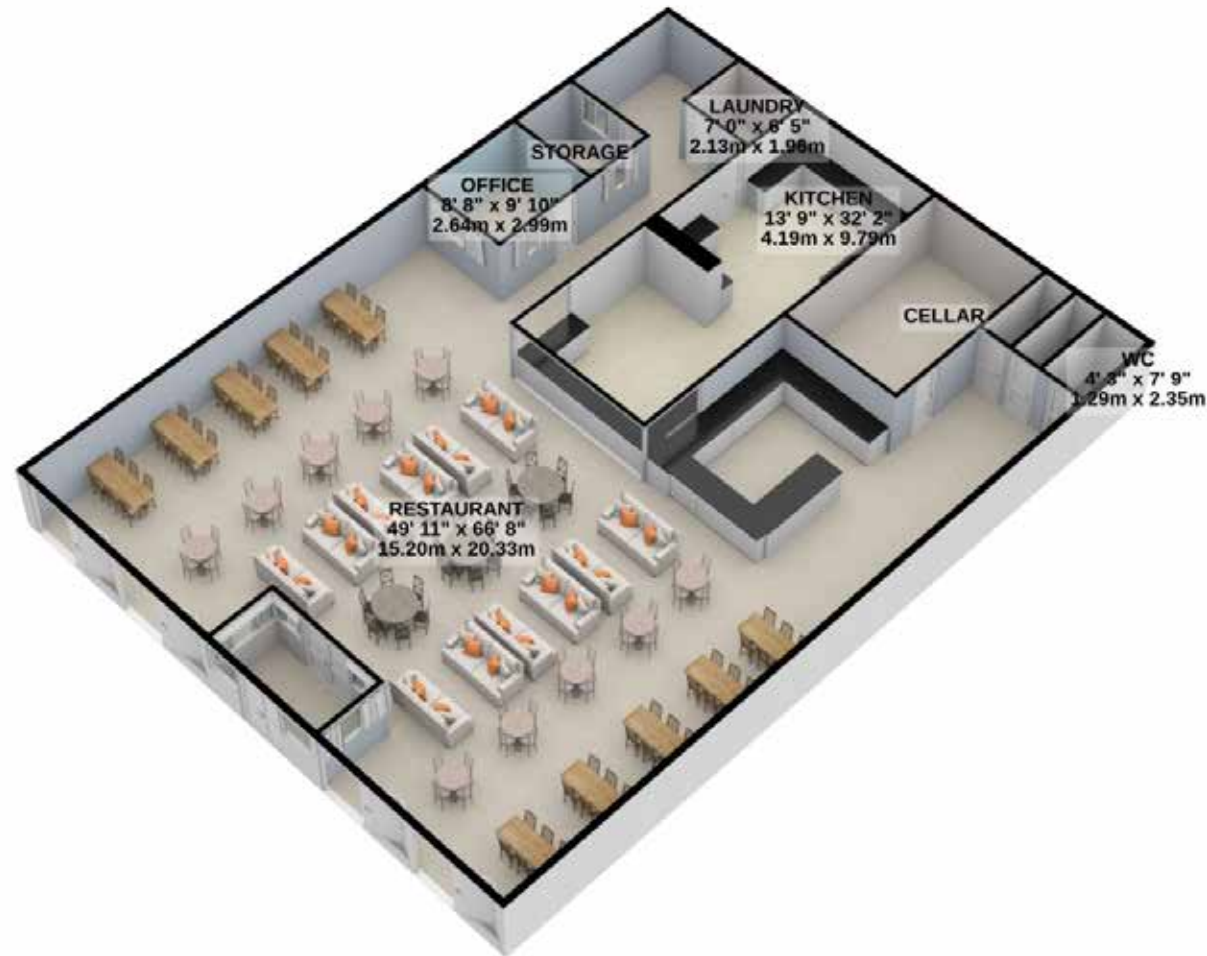

TOTAL FLOOR AREA : 3319 sq.ft. (308.3 sq.m.) approx.

For illustrative purposes only. Decorative finishes, fixtures, fittings and furnishings do not represent the current state of the property. Measurements are approximate. Not to scale.

Made with Metropix © 2021