



28 Brockhurst Park, Marldon

Paignton

Guide Price **£325,000**

ABSOLUTE



28 Brockhurst Park

Marldon, Paignton

Desirable 3-storey townhouse in Marldon village. Fitted kitchen, spacious lounge with fireplace, 3 double bedrooms, integral garage, and low-maintenance gardens. Gas central heating, uPVC double glazing. No onward chain. Viewing recommended.

Council Tax band: D

Tenure: Freehold

EPC Energy Efficiency Rating: C

EPC Environmental Impact Rating: C

- 3 Storey town house
- 3 Double bedrooms
- Fitted kitchen/dining room with integrated appliances
- Spacious lounge with Juliette balcony overlooking the green to the front of the property
- Cloakroom on the first floor
- En-suite shower room and family bathroom
- Integral garage with side door to hallway
- Enclosed low maintenance rear garden
- EPC - C Council tax band D



28 Brockhurst Park

Marldon, Paignton

The property is situated in the pretty South Hams village of Marldon bordering some of South Devon's most picturesque rolling countryside. Marldon is full of history and character and is well served by two good pubs, village shops, a post office, a well-regarded primary school, a church and a very active community hall hosting various clubs. Plenty of countryside walks around the area are right on the doorstep whilst the sandy beaches of Paignton are approximately 3 miles away and the picturesque village of Totnes is just over 5 miles away. The property gives excellent access to the Ring Road linking both nearby towns of Torquay and Newton Abbot.

Absolute Sales & Lettings

Absolute Sales & Lettings, 27 Hyde Road - TQ4 5BP

01803 890110

paignton@movewithabsolute.co.uk

<http://www.movewithabsolute.co.uk>



ABS

Ground Floor

Approx. 47.2 sq. metres (507.6 sq. feet)

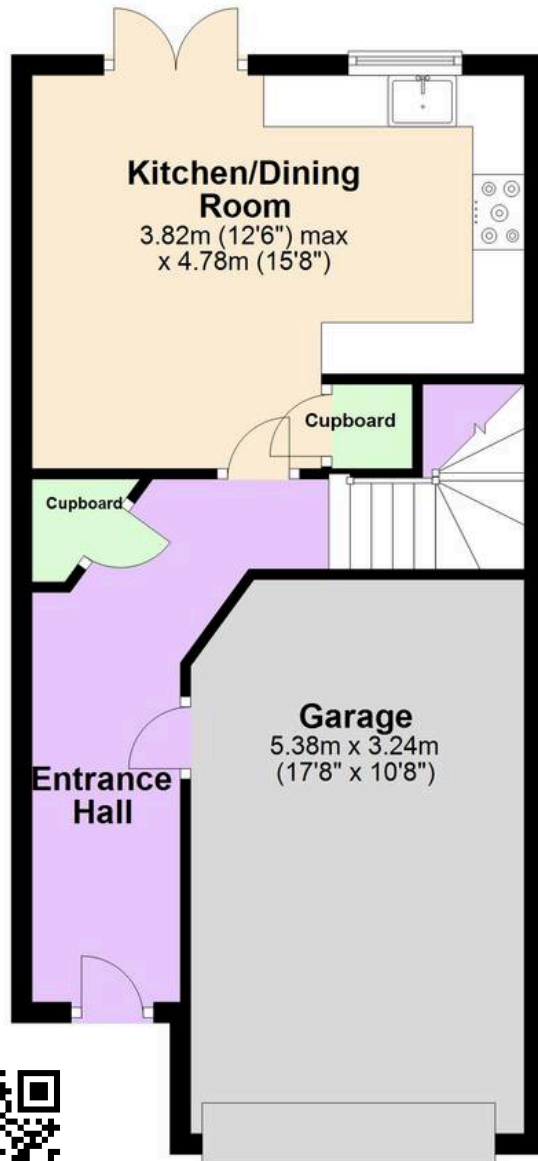

First Floor

Approx. 48.7 sq. metres (524.1 sq. feet)

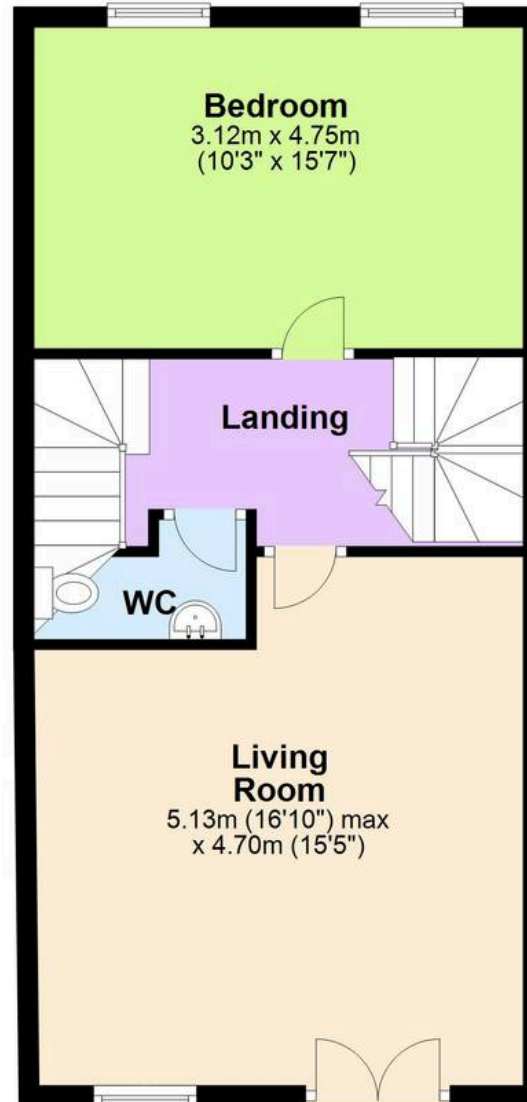

Second Flr

Approx. 48.8 sq. metres (524.9 sq. feet)

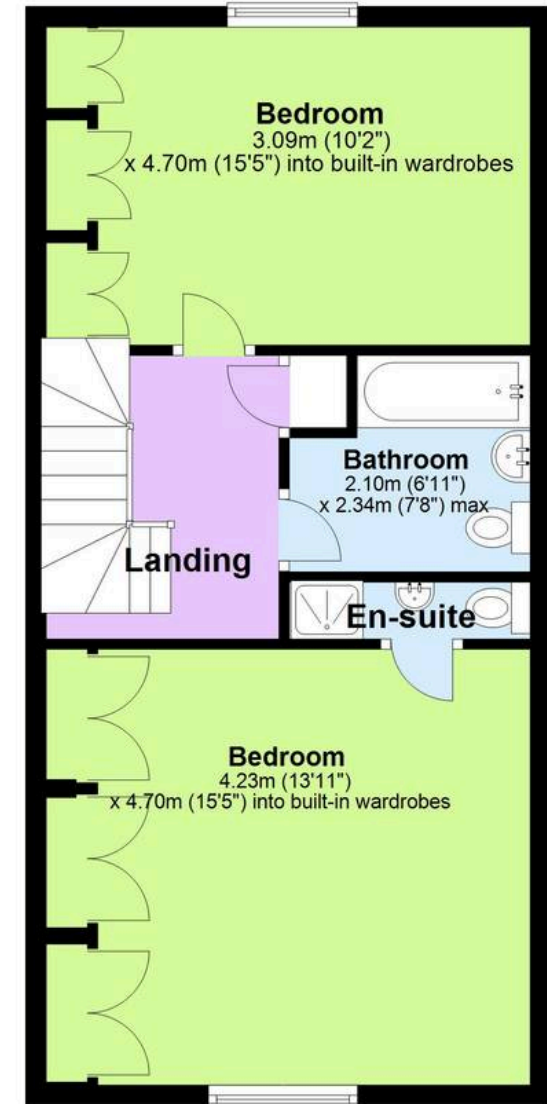

Total area: approx. 144.6 sq. metres (1556.6 sq. feet)

Approx
Plan produced using PlanUp.

