



Primley Court Waterleat Road, Paignton

Paignton

Guide Price £200,000



Primley Court Waterleat Road

Paignton,

Charming 2-bed townhouse in Paignton with spacious living room, kitchen/diner, rear garden, garage, upgraded with partial uPVC glazing, boiler, and roof. Conveniently located near schools, shops, and good road links, offering comfort and accessibility in a sought-after area. Schedule a viewing now!

Council Tax band: B

Tenure: Freehold

- Terraced two bedroom town house
- Kitchen/diner with access to rear tiered garden
- Close To Schools & Main Bus Routes
- Quiet cul-de-sac location
- Light & spacious living room
- Bathroom/WC
- Gas central heating & uPVC double glazing
- Views across Paignton
- Garage & parking
- Conveniently located near shops, local amenities & good road links



ABSOLUT



ABSOLUT

Primley Court Waterleat Road

Paignton,

The property occupies a convenient residential cul-de-sac position, being within close proximity to the ring road that connects Torquay, Newton Abbot and Exeter beyond. Paignton town centre and seafront, with their array of shops, facilities and amenities is all within walking distance. Choice of secondary schools right on your doorstep.

Absolute Sales & Lettings

Absolute Sales & Lettings, 27 Hyde Road - TQ4 5BP

01803 890110

paignton@movewithabsolute.co.uk

<http://www.movewithabsolute.co.uk>



Ground Floor

Approx. 24.4 sq. metres (262.7 sq. feet)

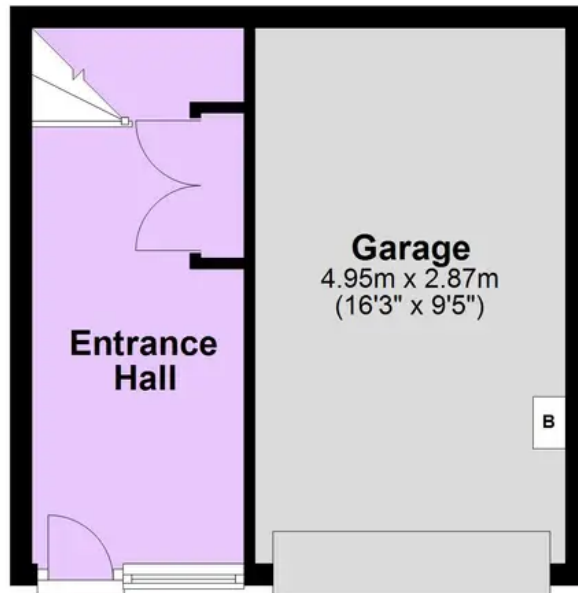

First Floor

Approx. 36.5 sq. metres (393.3 sq. feet)

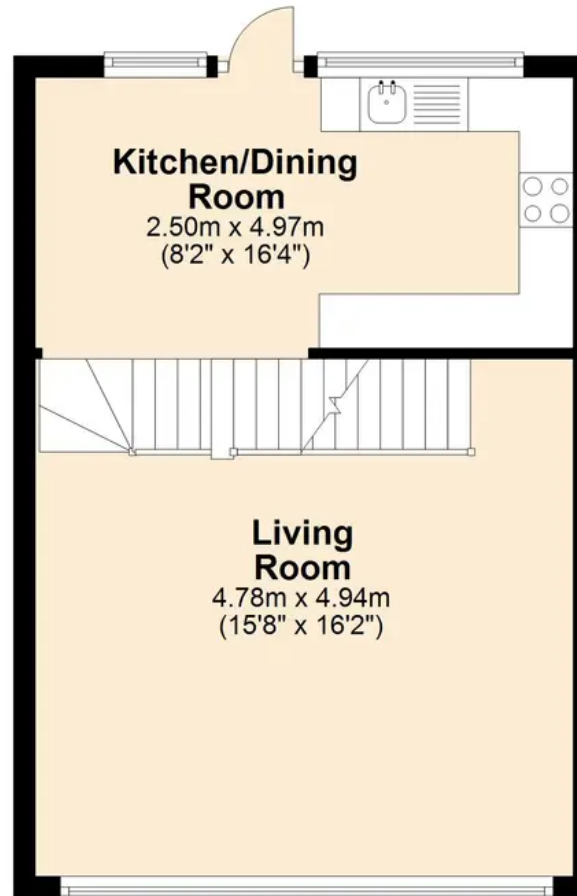

Second Floor

Approx. 36.8 sq. metres (395.9 sq. feet)

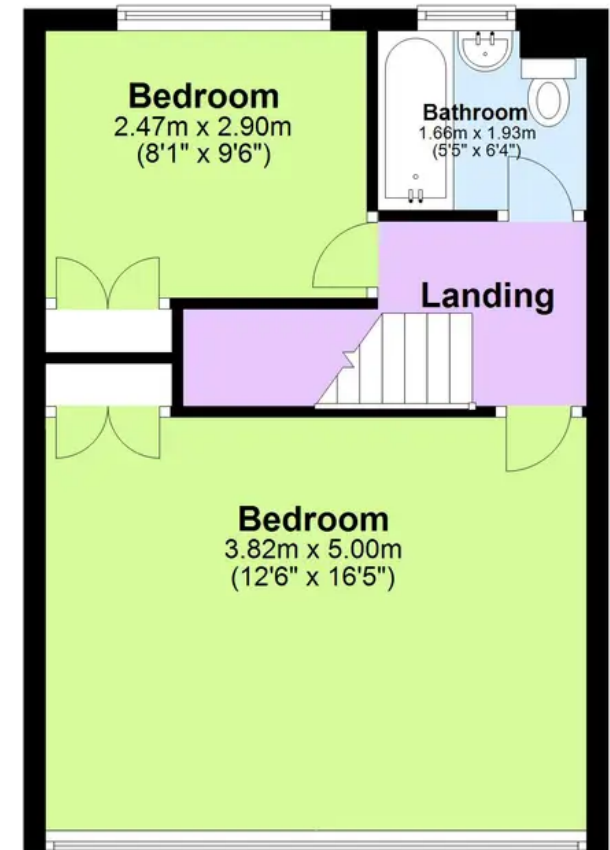

Total area: approx. 97.7 sq. metres (1051.8 sq. feet)

Approx
Plan produced using PlanUp.

