



102 Penwill Way, Paignton

Paignton

£325,000

ABSOLUTE



## 102 Penwill Way

Paignton, Paignton

Charming three bedroomed detached bungalow with sea views on a corner plot. Spacious lounge/dining room with panoramic views, modern kitchen, three bedrooms, fitted bathroom. Garden ready for transformation. Single garage, driveway. Great potential for dream home by the sea in sought-after area. Council Tax band: D

Tenure: Freehold

EPC Energy Efficiency Rating: C

EPC Environmental Impact Rating: C

- Detached bungalow with lovely sea views
- Good sized lounge/dining room with sea views
- Kitchen/breakfast room with sea view
- Three bedrooms
- Modern fitted bathroom/shower room
- Corner plot gardens
- Single garage
- Driveway parking
- In need of modernisation





## 102 Penwill Way

Paignton, Paignton

Charming three bedroomed detached bungalow with sea views on a corner plot. Spacious lounge/dining room with panoramic views, modern kitchen, three bedrooms, fitted bathroom. Garden ready for transformation. Single garage, driveway. Great potential for dream home by the sea in sought-after area. Council Tax band: D

Tenure: Freehold

EPC Energy Efficiency Rating: C

EPC Environmental Impact Rating: C

- Detached bungalow with lovely sea views
- Good sized lounge/dining room with sea views
- Kitchen/breakfast room with sea view
- Three bedrooms
- Modern fitted bathroom/shower room
- Corner plot gardens
- Single garage
- Driveway parking
- In need of modernisation



# 102 Penwill Way

Paignton, Paignton

Situated in a popular residential location with a range of local amenities including leisure centre, pleasant walks, beach and supermarket. Local beaches are South Sands and North Sands at Goodrington with excellent facilities and park. Paignton town centre offers a range of shopping plus cafes, bars and restaurants. There is a lovely sandy beach, pleasure green, pier and picturesque harbour.

## Absolute Sales & Lettings

Absolute Sales & Lettings, 27 Hyde Road - TQ4 5BP

01803 890110

paignton@movewithabsolute.co.uk

<http://www.movewithabsolute.co.uk>



# Ground Floor

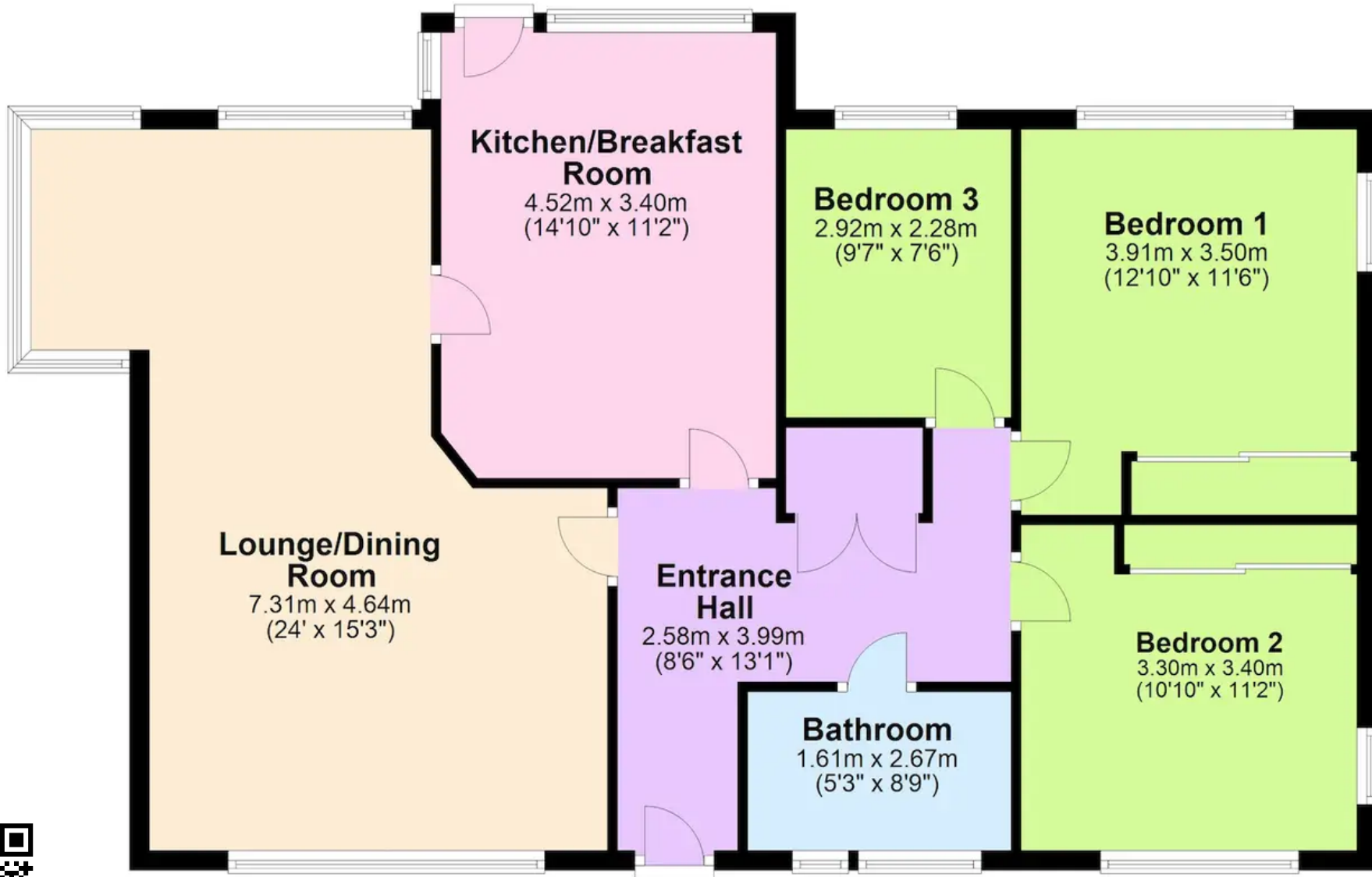

Total area: approx. 95.8 sq. metres (1031.7 sq. feet)

Approx  
Plan produced using PlanUp.

