

23 Railway Walk, Barnsley, S71 4GL

Do not miss out on this stunning 3 bed semi detached property which sits on the popular new development in Royston.

This stone built property is perfect for any first time buyer or small family with a low maintenance garden to the rear overlooking the fields.

As you enter the property through the hallway, the spacious lounge is on the right hand side, with gorgeous windows bringing plenty of light in. The stunning kitchen benefits from integrated appliances and plenty of cupboards. The kitchen/dining area has double doors which leads into the low maintenance garden, with fields to the rear. There is also a storage cupboard and downstairs WC.

Upstairs there is a house bathroom, master with fitted wardrobes and an en suite plus 2 further bedrooms. Outside there is off road parking for 2 vehicles to the front and the local park and amenities are within walking distance. The property is also close to good schools and great commuter links,

Get in touch now to arrange you viewing.

- 3 Bed Stone Build Semi Detached Home
- Perfect for First Time Buyers
- Open Plan Kitchen/Diner
- Master Bedroom with Fitted Wardrobes & En-Suite
- 2 Further Bedrooms
- Tastefully Decorated Throughout
- Off Road Parking
- Low Maintenance Rear Garden
- Close to Schools, Parks, amenities and

£230,000

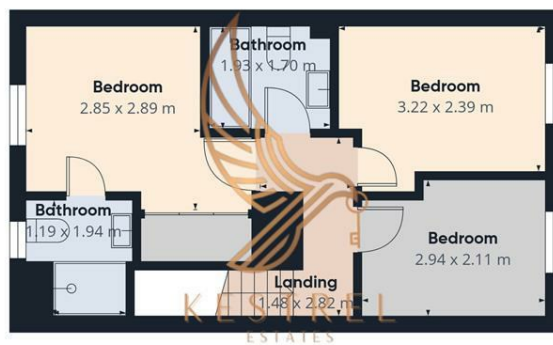
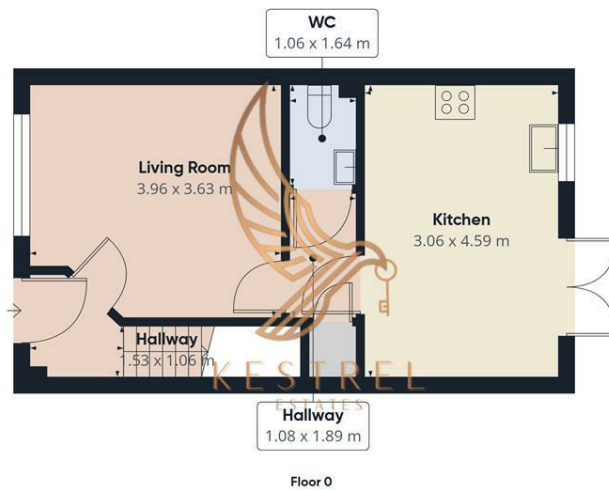

Approximate total area[®]
70 m²

(1) Excluding balconies and terraces

Calculations reference the RICS IPMS 3C standard. Measurements are approximate and not to scale. This floor plan is intended for illustration only.

GIRAFFE360

