

17 Hope Street, Milnsbridge, Huddersfield, HD3 4JP

Nestled on the charming Hope Street in Milnsbridge, this delightful two-bedroom end terrace house presents an excellent opportunity for both first-time buyers and savvy investors. Recently renovated, the property boasts a modern and inviting atmosphere, making it a perfect place to call home.

Spanning an impressive 936 square feet, the house features a well-proportioned reception room that offers ample space for relaxation and entertaining. The two bedrooms are thoughtfully designed, providing comfortable living quarters for individuals or small families. The bathroom is conveniently located, ensuring ease of access for all residents.

One of the standout features of this property is its prime location. Situated close to local amenities, residents will enjoy easy access to shops, cafes, and essential services, enhancing the overall convenience of daily life.

This end terrace house not only offers a stylish and contemporary living space but also represents a sound investment opportunity in a sought-after area. Whether you are embarking on your journey as a homeowner or looking to expand your property portfolio, this residence on Hope Street is certainly worth considering. Don't miss the chance to view this lovely home and envision the possibilities it holds for you.

- 2 BEDROOM END TERRACE
- RECENTLY RENNOVATED
- PERFECT FOR FIRST TIME BUYERS
- IDEAL FOR INVESTORS
- SPACIOUS KITCHEN
- CLOSE TO LOCAL AMENITIES

£110,000



Floor -1

Hallway
1.13 x 1.15 m

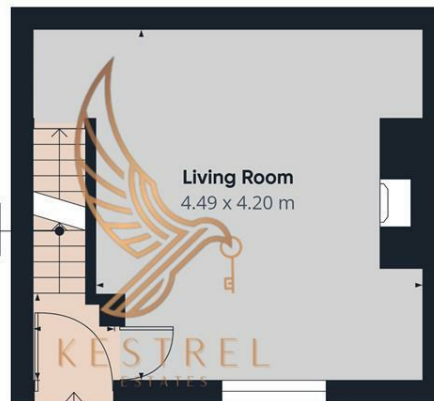

Floor 0



Floor 1



Approximate total area⁽¹⁾

64.1 m²

Reduced headroom

0.6 m²

(1) Excluding balconies and terraces

Reduced headroom

Below 1.5 m

While every attempt has been made to ensure accuracy, all measurements are approximate, not to scale. This floor plan is for illustrative purposes only.

Calculations were based on RICS IPMS 3C standard. Please note that, calculations were adjusted by a third party and therefore may not comply with RICS IPMS 3C.

GIRAFFE360

