

## 2 Park Farm Gardens, South Kirkby, Pontefract, WF9 3AF

This 3 bedroomed property is perfect for first time buyers and families alike.

Being conveniently located close to parks, amenities and local schools, this home ticks all the boxes.

As you enter the property via the porch, the WC is on the right and the spacious lounge leads onto the dining room and kitchen. The dining room benefits from double doors leading onto the garden with beautiful decked area. The kitchen is modern with an expanse of units and has an integrated oven and hob.

Upstairs there are 3 bedrooms, the master having an en-suite. This gorgeous home is beautifully decorated throughout and ready to move straight in to.

Externally there is off road parking to the front and an enclosed rear garden with patio area and pergola.

Don't miss this beautiful property

- 3 Bedroomed Townhouse
- Beautifully decorated throughout
- Spacious Living Accommodation
- Kitchen/Diner
- Master Bedroom with En-Suite
- Enclosed Rear Garden with Patio Area
- Off Road Parking
- MUST SEE

£160,000

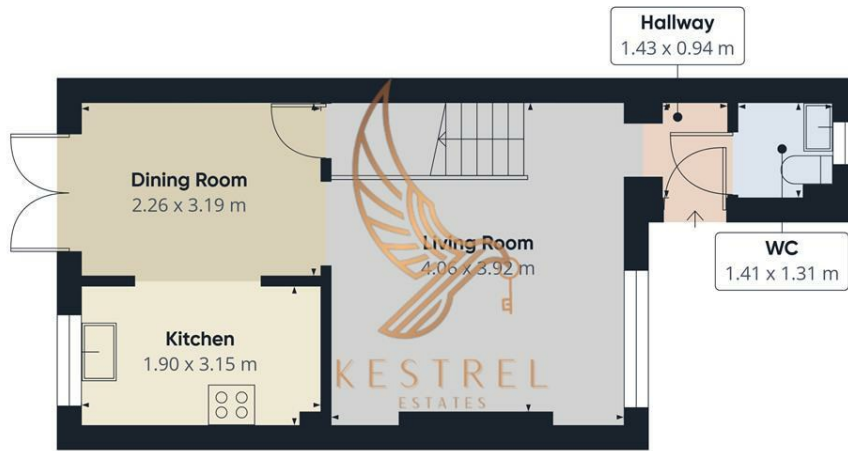

Floor 0

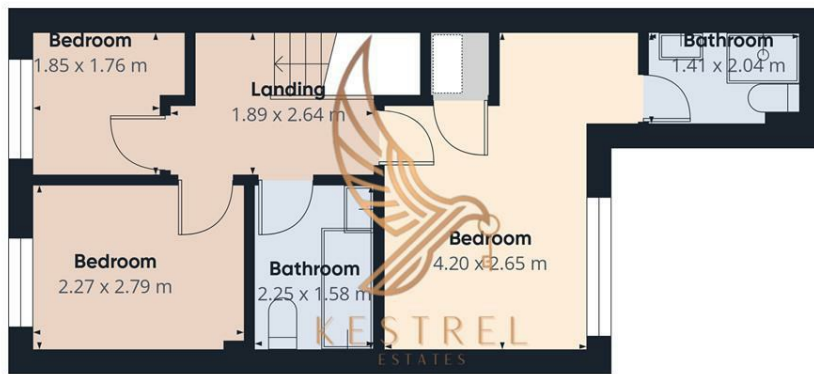

Floor 1



Approximate total area<sup>1)</sup>  
63.8 m<sup>2</sup>

(1) Excluding balconies and terraces.

While every attempt has been made to ensure accuracy, all measurements are approximate, not to scale. This floor plan is for illustrative purposes only.

Calculations were based on RICS IPMS 3C standard. Please note that, calculations were adjusted by a third party and therefore may not comply with RICS IPMS 3C.

GIRAFFE360

