



15 Landsdown Avenue, South Kirkby, WF9 3EU

Hitting the market with no chain is this lovely 3 bed property on this popular street in South Kirkby.

Being conveniently located close to schools, amenities and commuter links, this home ticks all the boxes for first time buyers and families.

As you enter the property through the porch you head into the spacious lounge with open staircase. The modern open plan kitchen/diner sits at the rear of the property leading into the well maintained garden and patio area.

Upstairs there are 3 generous bedrooms and a light and airy bathroom.

Outside there is off road parking and gardens to the front and rear.

The property is well maintained inside and out and ready for someone to put their own stamp on.

NB: some of the photos are virtually staged.

- 3 Bed Home
- Cul-de-Sac Location
- Spacious Lounge
- Open plan Kitchen/Diner
- Gardens to Front & Rear
- Off Road Parking
- Perfect for Families & First Time Buyers
- Great Commuter Links/Amenities

£175,000

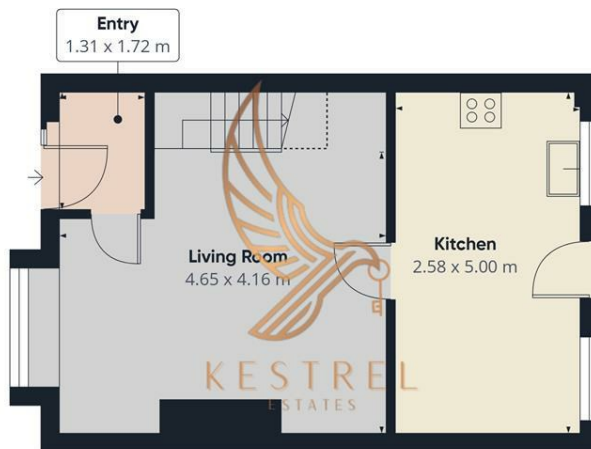

Floor 0

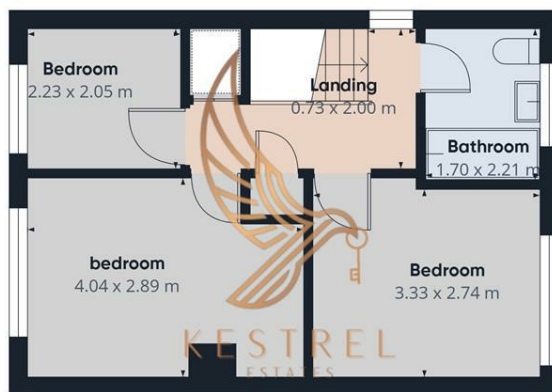

Floor 1



Approximate total area⁽¹⁾
69.8 m²

Reduced headroom
1.3 m²

(1) Excluding balconies and terraces

Reduced headroom
..... Below 1.5 m

While every attempt has been made to ensure accuracy, all measurements are approximate, not to scale. This floor plan is for illustrative purposes only.

Calculations were based on RICS IPMS 3C standard. Please note that, calculations were adjusted by a third party and therefore may not comply with RICS IPMS 3C.

GIRAFFE360

