



42 Hoyle Mill Road, Barnsley, S70 3EL

Hitting the market is this well presented 3 bed inner townhouse which is conveniently located close to shops, schools and fantastic amenities.

The spacious lounge with open staircase leads off the porch together with the downstairs WC. The open plan kitchen benefits from an expanse of units and an integrated oven and hob, together with patio doors leading to the garden, making this room light and airy and perfect for entertaining.

Upstairs there are 3 well proportioned bedrooms, the master having a gorgeous en-suite.

Externally there is an enclosed rear garden with patio area, perfect for catching the summer sun and parking to the rear of the property.

Call now to arrange your viewing!!

- Well Presented 3 Bed Townhouse
- Spacious Lounge
- Open Plan Kitchen/Diner
- Downstairs WC
- Master Bedroom with En-Suite
- Sunny Garden with Patio Area
- Off Road Parking

£180,000

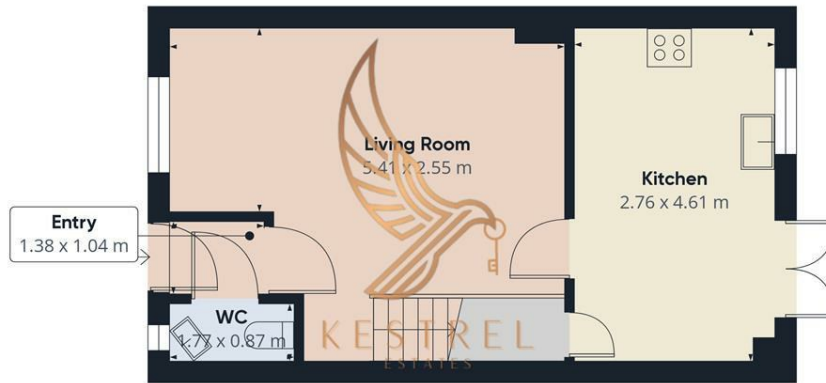

Floor 0

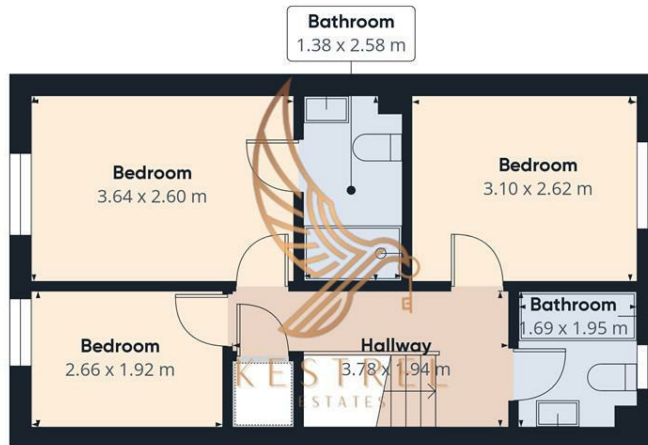

Floor 1



Approximate total area[®]
71.6 m²

(1) Excluding balconies and terraces

While every attempt has been made to ensure accuracy, all measurements are approximate, not to scale. This floor plan is for illustrative purposes only.

Calculations are based on RICS IPMS 3C standard.

GIRAFFE360

