



216 Priory Road, Featherstone, Pontefract, WF7 5JW

Located on Priory Road, Featherstone, this 1940s three-bed end-terrace is a fantastic renovation opportunity for first-time buyers or investors looking to add value.

The home features a spacious reception room, three well-sized bedrooms, and a bathroom ready for modernisation. The large garden provides plenty of outdoor space for relaxing, gardening, or entertaining.

Situated close to local shops, schools, and transport links, this property has great potential to become a lovely family home or a profitable rental investment. Don't miss out—viewing is a must!

- 3 BEDROOM END-TERRACE
- IN NEED OF RENOVATION
- GOOD SIZED BEDROOMS
- SPACIOUS GARDEN
- PERFECT FOR INVESTORS OR FIRST TIME BUYERS
- CLOSE TO LOCAL SHOPS AND AMENITIES

£145,000

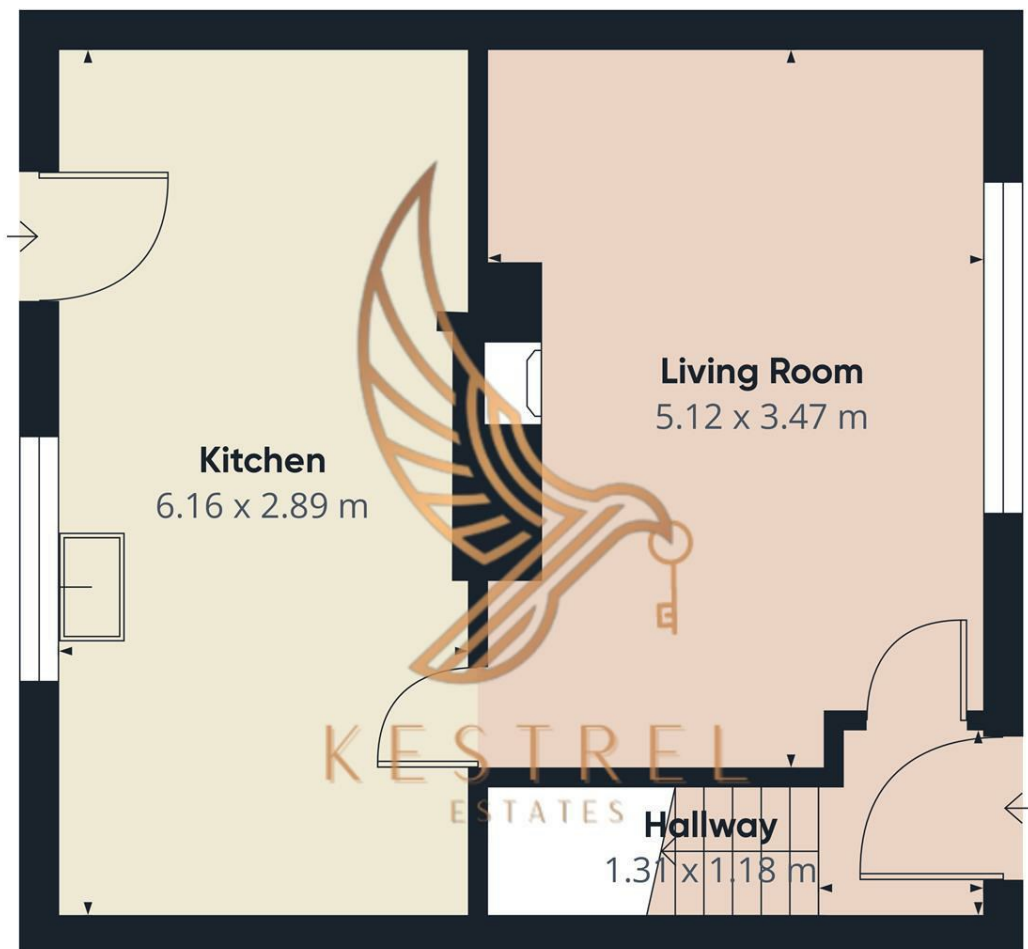

Floor 0



Approximate total area[®]
38.62 m²

(1) Excluding balconies and terraces.

While every attempt has been made to ensure accuracy, all measurements are approximate, not to scale. This floor plan is for illustrative purposes only.

Calculations were based on RICS IPMS 3C standard. Please note that, calculations were adjusted by a third party and therefore may not comply with RICS IPMS 3C.

GIRAFFE360

Energy Efficiency Rating		
	Current	Potential
Very energy efficient - lower running costs		
(92 plus) A		
(81-91) B		
(69-80) C		
(55-68) D		
(39-54) E		
(21-38) F		
(1-20) G		
Not energy efficient - higher running costs		
England & Wales	EU Directive 2002/91/EC	