



1 Askham Grove, Upton, WF9 1LT

This stunning 3/4 bed detached bungalow sits on an envious plot with wrap around garden, benefits from off road parking and a garage.

Internally the property has been decorated to a very high standard, as you enter through the porch into the hallway, you will find a spacious hallway, with the lounge leading off to the right, the well equipped kitchen has an expanse of units. The dining room/potential 4 bedroom/second living room opens up onto the garden through the double doors.

The main bathroom with bath and shower is located off the dining room, there is also a separate WC and 3 bedrooms.

Externally the house is surrounded by gardens and is enclosed for privacy, there is also a garage.

This home in Upton really must be viewed to appreciate the space on offer.

£275,000

- 3/4 Bed Detached Bungalow
- Beautifully Decorated
- Spacious Lounge
- Fantastic Kitchen
- Bedroom 4/Dining Room/2nd Living Room
- Master Bathroom with Bath & Shower
- Separate WC
- Garage & Off Road Parking
- Private Position
- Great Location Close to Amenities

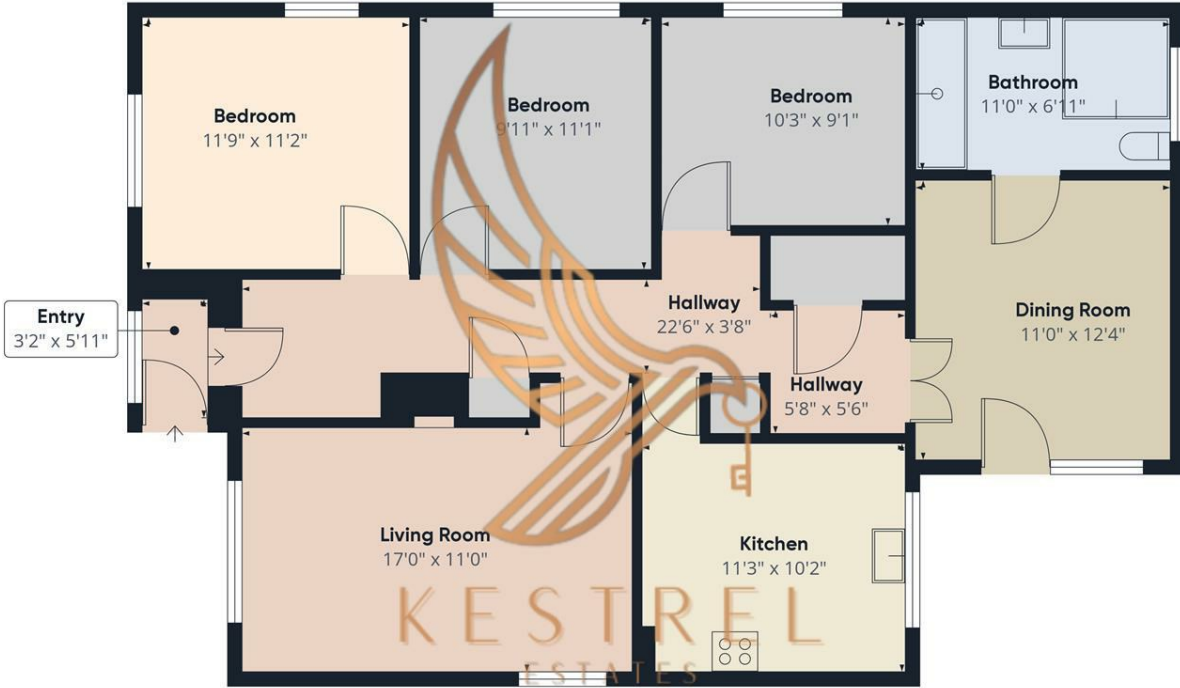

Approximate total area[®]
1051.96 ft²

(1) Excluding balconies and terraces

While every attempt has been made to ensure accuracy, all measurements are approximate, not to scale. This floor plan is for illustrative purposes only.

Calculations are based on RICS IPMS 3C standard.

GIRAFFE360

Floor 0 Building 1

Energy Efficiency Rating		Current	Potential
Very energy efficient - lower running costs			
(92 plus) A			
(81-91) B			
(69-80) C			
(55-68) D			
(39-54) E			
(21-38) F			
(1-20) G			
Not energy efficient - higher running costs			
England & Wales		EU Directive 2002/91/EC	
		68	81