



## 2 Thistle Drive, Upton, WF9 1NQ

You do not want to miss out on this beautiful 4 bedroomed detached home for sale in Upton.

The modern spacious lounge sits off the hallway and leads into the beautifully decorated kitchen / diner, which in turn leads into the conservatory and into the well maintained garden.

The garage has been converted to create an additional room which could be used as a second living room, play room or office.

Upstairs you will find 4 bedrooms, master with en suite and fitted wardrobes and the house bathroom.

This gorgeous home on Thistle Drive is worthy of an internal inspection to really appreciate the space on offer.

**£290,000**

- Stunning 4 Detached Home
- Converted Garage to Office Space/Play Room
- Beautiful Kitchen/Diner Leading
- Conservatory Leading on to the Garden
- Downstairs WC
- Master with En-Suite
- 3 Further Bedrooms
- Off Road Parking for 2 Vehicles
- Great Location

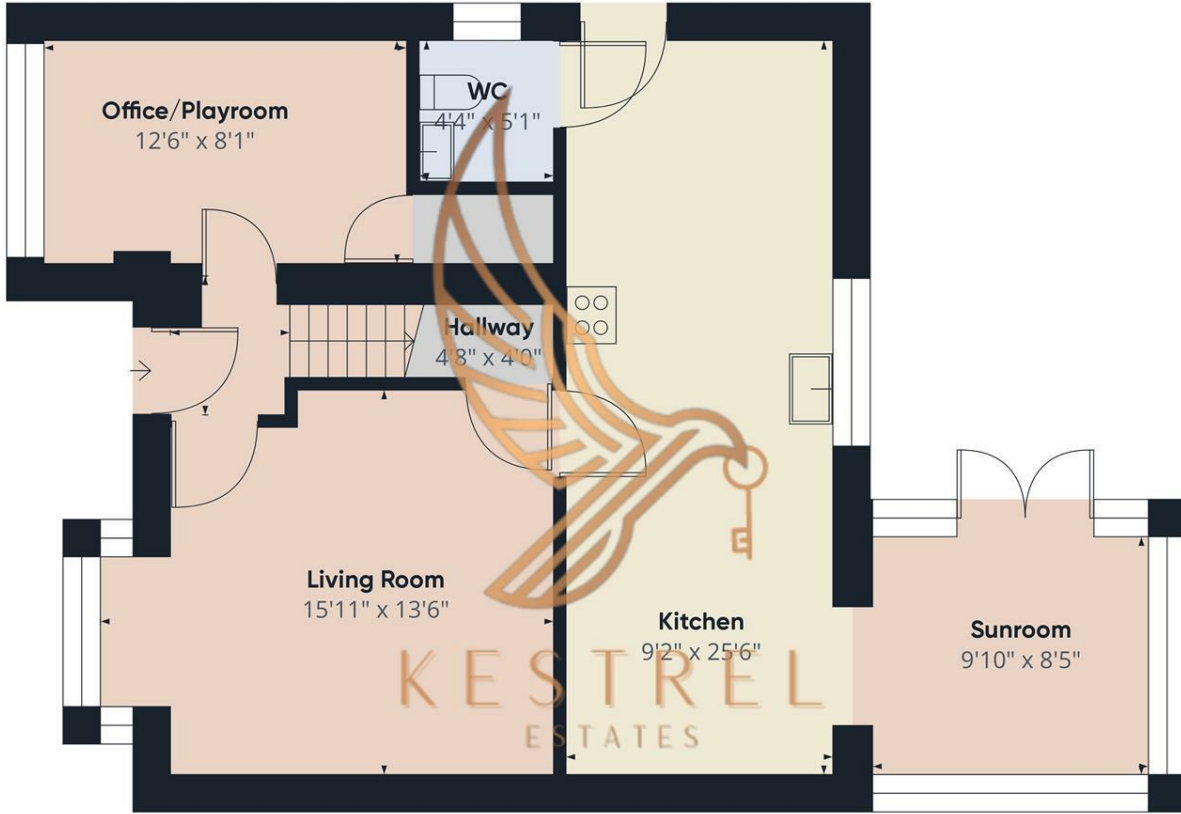

Floor 0

Approximate total area<sup>(1)</sup>  
714.29 ft<sup>2</sup>

(1) Excluding balconies and terraces

While every attempt has been made to ensure accuracy, all measurements are approximate, not to scale. This floor plan is for illustrative purposes only.

Calculations are based on RICS IPMS 3C standard.

GIRAFFE360

