

4 Buttercup Close, Upton, Pontefract, WF9 1ND

Hitting the market on this popular development in Upton is this gorgeous former show home.

With an open plan living/diner, conservatory, beautiful kitchen, utility and integral garage with electric door, this home has it all. Upstairs there are 4 bedrooms, master with en-suite and house bathroom.

Externally there is a low maintenance garden to the rear and to the front there is off road parking and mature shrubbery giving extra privacy.

Get in touch now to arrange your viewing to really appreciate the space that is on offer.

£290,000

- Former Show Home
- 4 Bed Detached Home
- Master with En-Suite
- Open Plan Living/Dining & Conservatory
- Fitted Kitchen & Utility
- Integral Garage & Off Road Parking
- Mature front Garden & Low Maintenance Rear Garden
- Great Commuter Links & Amenities
- Perfect For Families

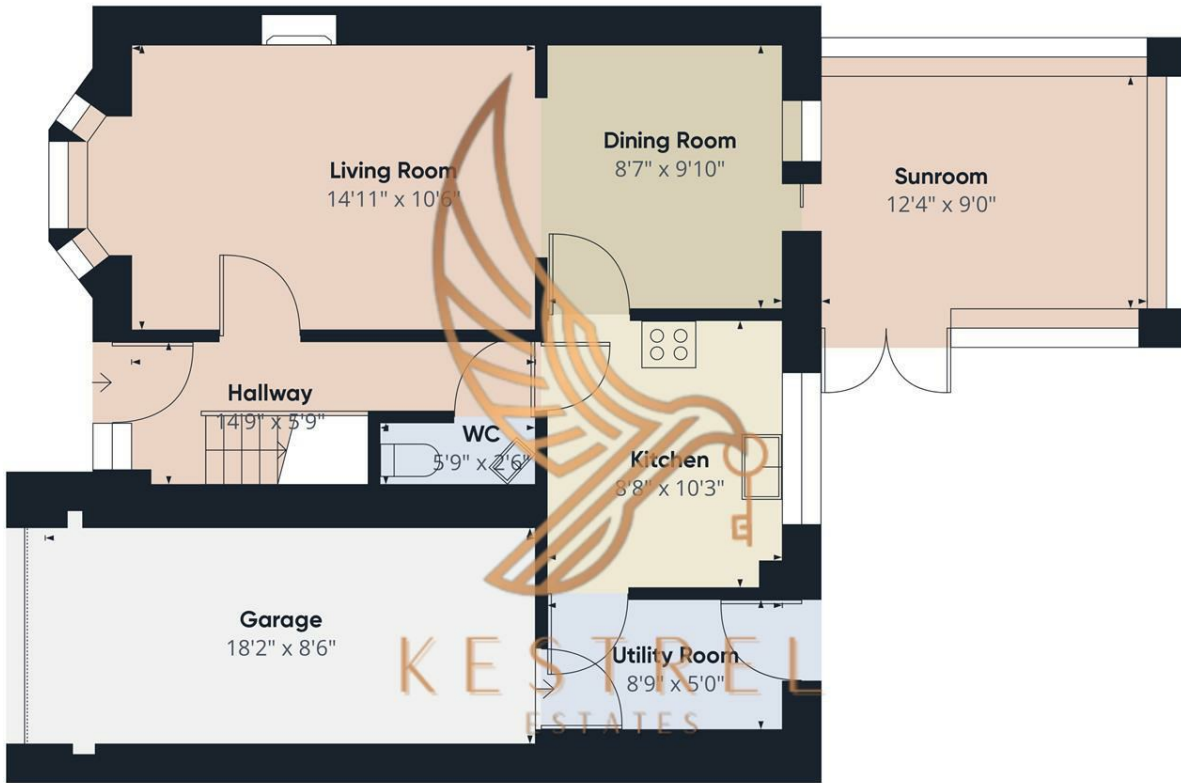

Approximate total area⁽¹⁾
776.63 ft²

(1) Excluding balconies and terraces

While every attempt has been made to ensure accuracy, all measurements are approximate, not to scale. This floor plan is for illustrative purposes only.

GIRAFFE 360

Floor 0

| Energy Efficiency Rating | | Current | Potential |
|---|--|----------------------------|-----------|
| Very energy efficient - lower running costs | | | |
| (92 plus) A | | | 84 |
| (81-91) B | | 71 | |
| (69-80) C | | | |
| (55-68) D | | | |
| (39-54) E | | | |
| (21-38) F | | | |
| (1-20) G | | | |
| Not energy efficient - higher running costs | | | |
| England & Wales | | EU Directive 2002/91/EC | |