

15 Ruby Lane, Upton, Pontefract, WF9 1FA

This is a Fantastic opportunity to purchase this amazing 4 bed detached house for sale in Upton with no onward chain.

With amazing views, a double driveway, open plan kitchen/diner, downstairs WC, 4 bedrooms, master with em-suite and a family bathroom, this home has it all.

The interior of this home is a credit to the current vendors and is ready to move straight in to.

The property briefly comprises a downstairs WC, living room, open plan kitchen/diner with utility area. upstairs you will find the house bathroom, 4 bedrooms and master with en suite and fitted wardrobes.

Externally there is a lawned area and parking for 2 vehicles to the front of the property and a well maintained enclosed rear garden with views over the fields.

Book your viewing today for this 4 bed detached house for sale on Ruby Lane.

- 4 Bed Detached Home
- Master With Fitted Wardrobes & En-Suite
- 3 Further Bedrooms
- Open Plan Kitchen/Diner
- Utility Area
- Off Road Parking
- Enclosed Rear Garden with Views
- No Onward Chain

£285,000

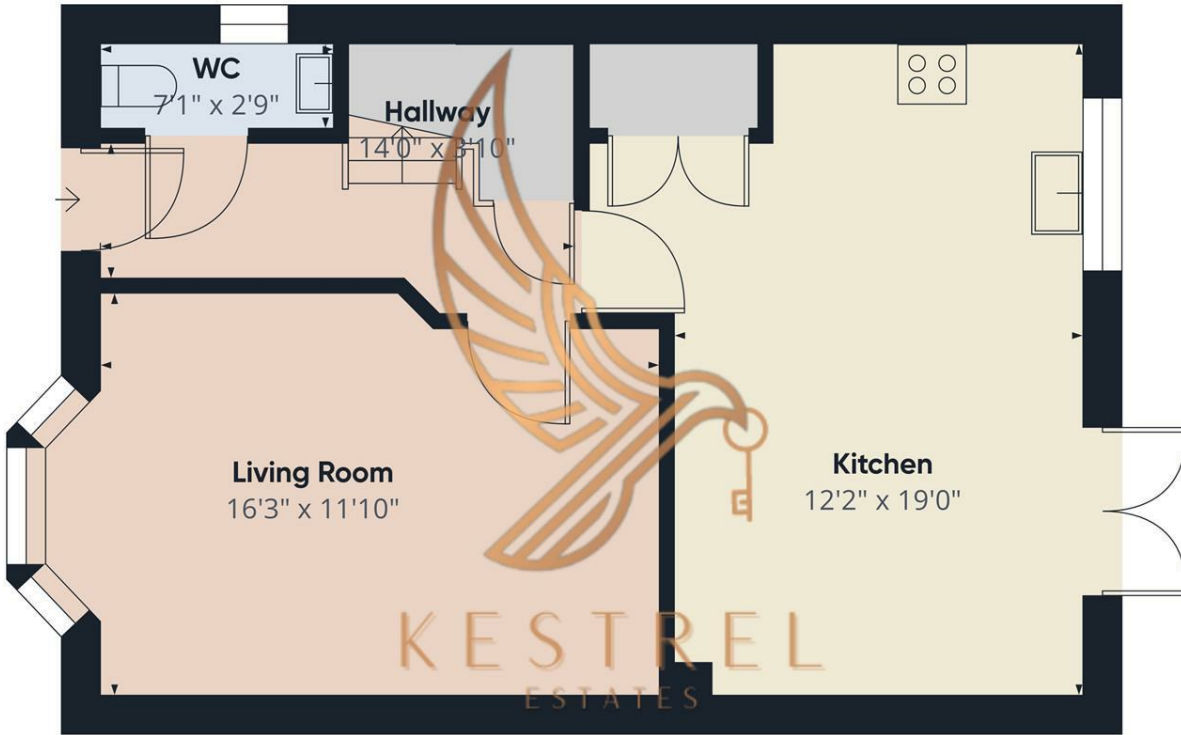

Approximate total area⁽¹⁾
557.39 ft²

(1) Excluding balconies and terraces

While every attempt has been made to ensure accuracy, all measurements are approximate, not to scale. This floor plan is for illustrative purposes only.

GIRAFFE360

Floor 0

Energy Efficiency Rating		Current	Potential
Very energy efficient - lower running costs			
(92 plus) A			93
(81-91) B		82	
(69-80) C			
(55-68) D			
(39-54) E			
(21-38) F			
(1-20) G			
Not energy efficient - higher running costs			
England & Wales		EU Directive 2002/91/EC	