



43 High Street, South Elmsall, Pontefract, WF9 2DA

On the market with Kestrel Estates is this impressive 6-bedroom detached property now available in South Elmsall. The residence features a generous lounge, dining room, kitchen, W/C, 6 bedrooms, 3 en-suites, and a family bathroom.

Situated on a delightful plot, the property includes a spacious garden and a driveway offering off-street parking. This is an opportunity you won't want to overlook!

- 6 Bed Detached Property
- Spacious Rear Garden
- Driveway Providing Off Street Parking
- Located On a Lovely Plot
- Close To Local Schools, Shops And Amenities
- Close To Local Transport Links

£450,000

Ground Floor

Approx. 32.5 sq. metres (349.6 sq. feet)



Second Floor

Approx. 106.9 sq. metres (1151.1 sq. feet)



First Floor

Approx. 112.1 sq. metres (1206.9 sq. feet)



Third Floor

Approx. 49.6 sq. metres (533.7 sq. feet)

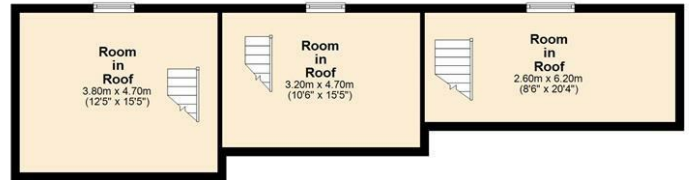

Total area: approx. 301.1 sq. metres (3241.3 sq. feet)

Energy Efficiency Rating		
	Current	Potential
<i>Very energy efficient - lower running costs</i>		
(92 plus) A		
(81-91) B		80
(69-80) C		
(55-68) D	63	
(39-54) E		
(21-38) F		
(1-20) G		
<i>Not energy efficient - higher running costs</i>		
England & Wales	EU Directive 2002/91/EC	