



32 Crawley Avenue, South Kirkby, Pontefract, WF9 3BN

This beautifully presented 5-bed semi-detached property in South Kirkby is perfect for any growing family boasting spacious and flexible accommodation throughout.

Briefly comprising of a lounge/dining room, kitchen, utility room, conservatory, W/C, 5 bedrooms and a family bathroom this home has it all.

Externally you will find a driveway providing off street parking and a spacious garden with a garage/garden room. Viewing is a must to truly appreciate the space on offer!

- Spacious 5 Bedroomed Home
- Modern Fitted Kitchen
- Spacious Garden
- Conservatory
- Stunning interior throughout
- Close to local schools and amenities
- Perfect for Families

£270,000

Ground Floor
Approx. 104.1 sq. metres (1120.1 sq. feet)

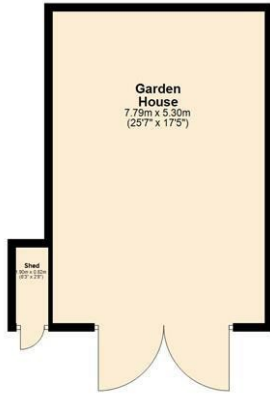

First Floor
Approx. 59.7 sq. metres (642.2 sq. feet)



Total area: approx. 163.7 sq. metres (1762.3 sq. feet)

Energy Efficiency Rating		
	Current	Potential
<i>Very energy efficient - lower running costs</i>		
(92 plus) A		
(81-91) B		
(69-80) C		
(55-68) D		
(39-54) E		
(21-38) F		
(1-20) G		
<i>Not energy efficient - higher running costs</i>		
England & Wales	EU Directive 2002/91/EC	