



2 Floors



3 Bedrooms



1 En suite

## KESWICK THREE BEDROOM HOME

A three bedroom semi-detached home with spacious lounge and fantastic open plan kitchen / dining area featuring utility area and French doors leading to the garden. Upstairs the master bedroom benefits from an en suite shower room.

# KESWICK THREE BEDROOM HOME

## ✦ DIMENSIONS

### First Floor:

#### Bedroom 1

3.08m x 3.01m  
10'1" x 9'11"

#### En Suite

#### Bedroom 2

2.67m x 3.13m  
8'9" x 10'3"

#### Bedroom 3 / Study

2.00m x 2.76m  
6'7" x 9'1"

#### Bathroom

### Ground Floor:

#### Lounge

3.75m x 4.61m  
12'3" x 15'2"

#### Kitchen / Dining

3.20m x 3.80m  
10'6" x 12'6"

(U) Utility area

(S) Storage

(C) Cloaks

◀▶ Measurement Points

△ External Access

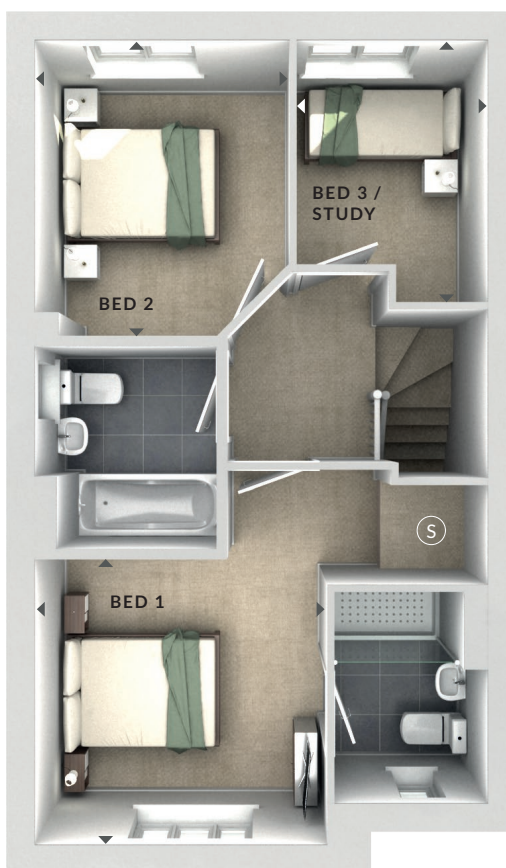

First Floor

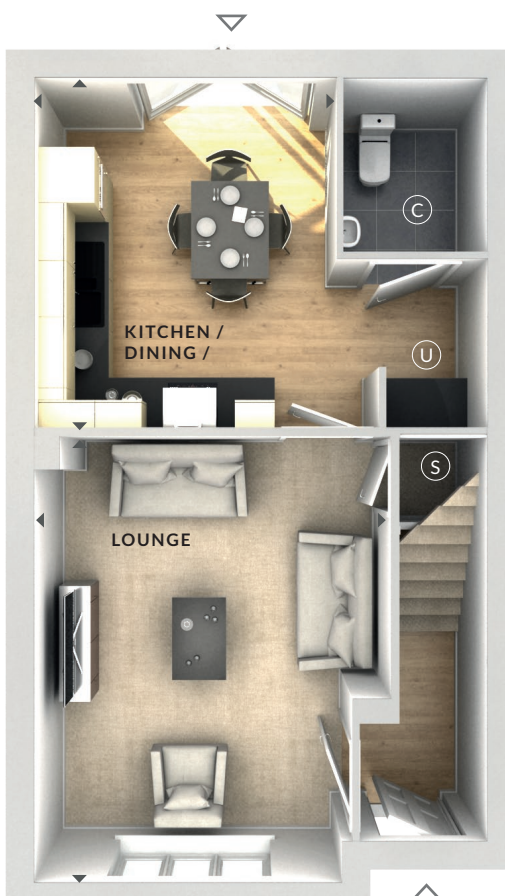

Ground Floor

© Bloor Homes  
M386B 7.0

These particulars are intended as a preliminary guide for prospective purchasers and should not be relied upon. The elevational treatment for individual house types shows a typical arrangement. Details of materials and design treatments may vary. Any artist impressions shown are not intended to represent any particular plot. Purchasers are advised to inspect the layout plan to establish the arrangement of the house and surrounding property. Internal layouts show a general arrangement which may vary from plot to plot. Room sizes given are approx. overall finished room sizes and subject to normal building tolerances (ie ± 75mm). In all instances purchasers are advised to inspect plot specific information available from our sales team. Nothing in these particulars or verbal assurance shall form or constitute part of any contract, and are given without any responsibility on behalf of Bloor Homes.

**BLOOR HOMES**