

venters
PROPERTY

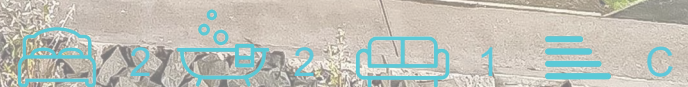

28 Williamson's Quay, Kirkcaldy, KY1 1JS

Offers over £135,000



Floor Plan

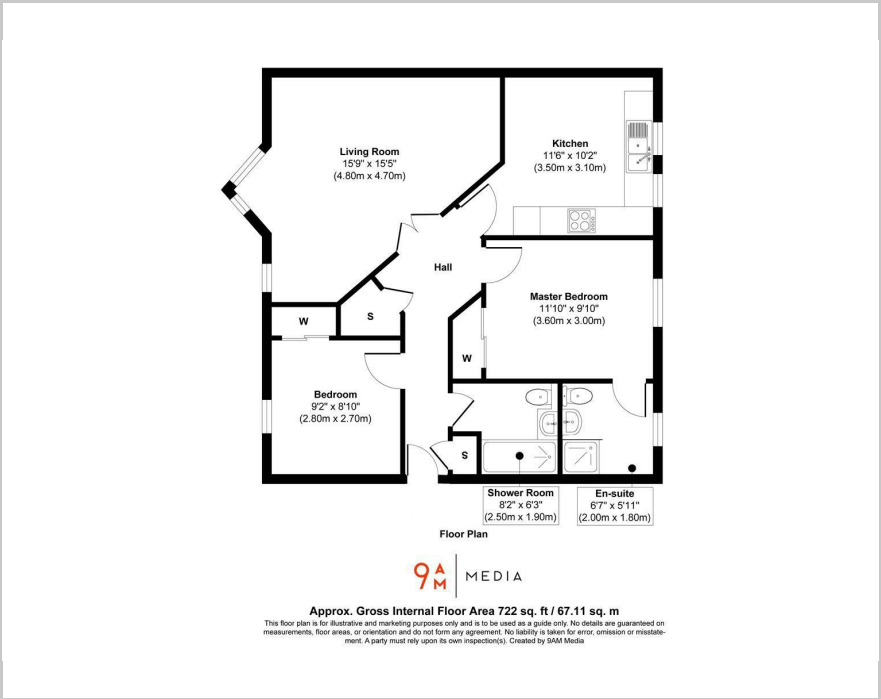

Area Map



These particulars, whilst believed to be accurate are set out as a general outline only for guidance and do not constitute any part of an offer or contract. Intending purchasers should not rely on them as statements of representation of fact, but must satisfy themselves by inspection or otherwise as to their accuracy. No person in this firm's employment has the authority to make or give any representation or warranty in respect of the property.

Accommodation

- Ground Floor Apartment
- Reception Hallway
- Lounge with Spectacular Views
- Breakfasting Kitchen
- Two Double Bedrooms
- Two Refitted Shower Rooms
- Gas Central Heating & Double Glazing
- Designated Parking Space
- Fantastic Coastal Location
- Close to Esplanade

Viewing

Please contact our Kirkcaldy Office on 01592 641000 if you wish to arrange a viewing appointment for this property or require further information.

Energy Efficiency Graph

