

TO LET



House - Semi-Detached

# NORTH CRAY ROAD, BEXLEY, KENT

Per Month

£2,400

## FEATURES

- New build home
- Private parking
- Close to Bexley station
- Open plan kitchen/dining
- 2 double bedrooms
- Private garden
- Unfurnished



BEXLEY HOMES

# 2 Bedroom House – Semi-Detached located in Bexley

New build 2-bedroom home in the heart of Bexley Village.  
A beautifully designed, brand-new 2-bedroom house located on North Cray Road, in the desirable heart of Bexley Village.

- Property features
- Bright, spacious entrance hall welcoming you into the home.
  - Open-plan kitchen diner on the ground floor, with patio doors that open onto a private rear garden – ideal for entertaining or relaxing outdoors.
  - White goods provided
  - Adjacent to the kitchen is a light and airy living room, offering a separate space for everyday lounging.
  - Conveniently placed modern ground-floor W/C.

Upstairs, the property comprises:

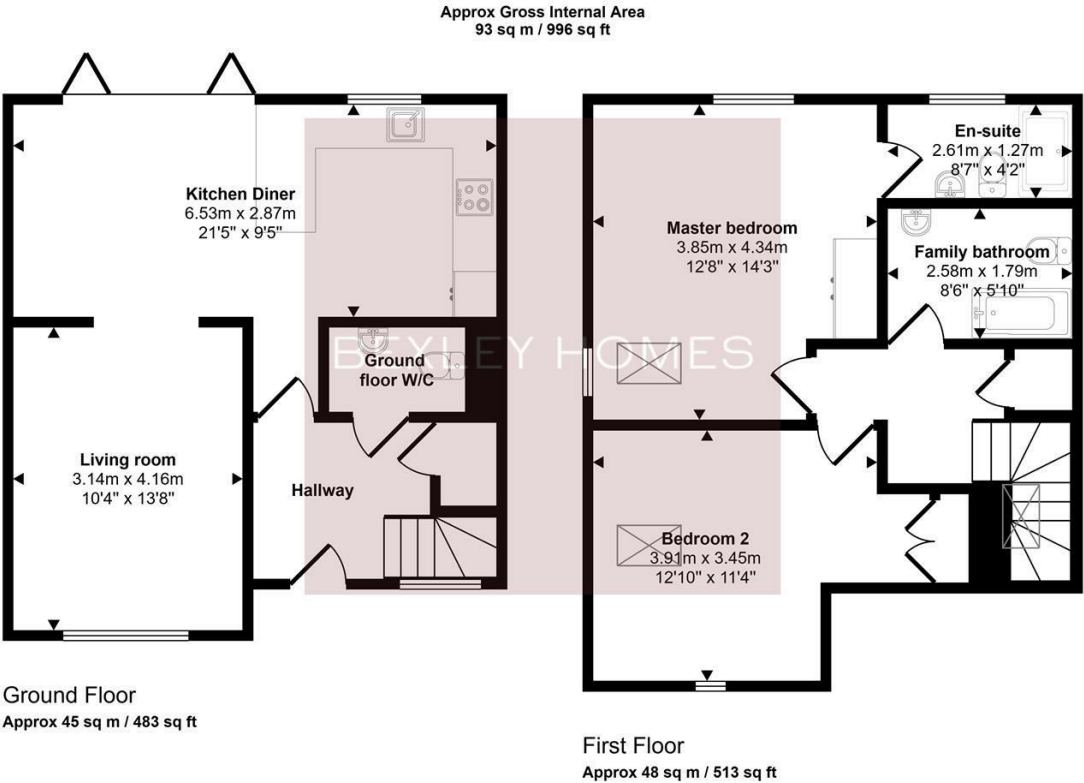

This floorplan is only for illustrative purposes and is not to scale. Measurements of rooms, doors, windows, and any items are approximate and no responsibility is taken for any error, omission or mis-statement. Icons of items such as bathroom suites are representations only and may not look like the real items. Made with Made Snappy 360.

Call us on  
01322 948500

Belvedere@bexleyhomes.co.uk  
www.bexleyhomes.co.uk

Council Tax Band  
New Build

Energy Efficiency Rating		
	Current	Potential
Very energy efficient - lower running costs		
(92 plus) <b>A</b>		
(81-91) <b>B</b>		
(69-80) <b>C</b>		
(55-68) <b>D</b>		
(39-54) <b>E</b>		
(21-38) <b>F</b>		
(1-20) <b>G</b>		
Not energy efficient - higher running costs		
<b>England &amp; Wales</b>	EU Directive 2002/91/EC	

Agents Note: Whilst every care has been taken to prepare these particulars, they are for guidance purposes only. All measurements are approximate and are for general guidance purposes only and whilst every care has been taken to ensure their accuracy, they should not be relied upon and potential buyers are advised to recheck the measurements.

