

Lewis  
King



11 Windermere Road, Crewe, CW2 8RJ

**£995 Per month**

 3  1  2  D



# 11 Windermere Road

Crewe, CW2 8RJ

- Available Now
- Recently Refreshed Throughout
- Kitchen/Diner Patio Doors To Garden
- Bathroom With Shower Over Bath
- Low Maintance Rear Garden
- 3 Bedroom Semi Detached
- Generous Size Lounge
- 2 Double Bedrooms
- Driveway Parking
- Council Tax Band B

\*\*\*Available Now\*\*\* Welcome to Windermere Road, Wistaston, Crewe - an excellent semi-detached house that boasts three bedrooms and recently enjoyed a refreshment throughout . This property is situated in a sought-after location, making it an ideal choice for those looking for a peaceful and convenient place to call home.

Available unfurnished, the ground floor briefly comprises: an entrance porch, generous sized living area with laminate flooring, and a stylish kitchen/diner with patio doors leading out to the rear garden. On the first floor are three bedrooms, two doubles, one single and a modern bathroom with a shower over the bath.

Externally to the front is driveway parking and a lawned garden, to the rear you will find a low maintenance garden with a shingled area.

Don't miss out on the opportunity to make this delightful house your new home. Windermere Road offers a wonderful blend of comfort, style, and convenience, making it a must-see for anyone in search of a property that ticks all the boxes. Contact us today to arrange a viewing and take the first step towards owning your dream home in Wistaston



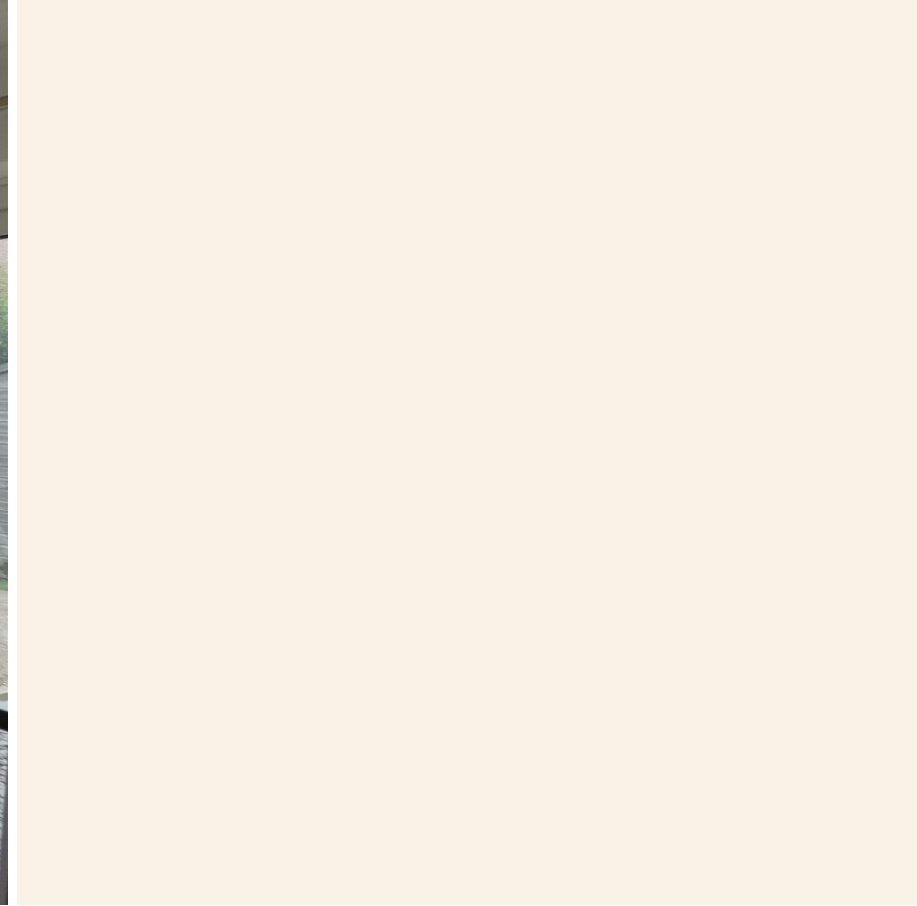

**Directions**





## Floor Plans

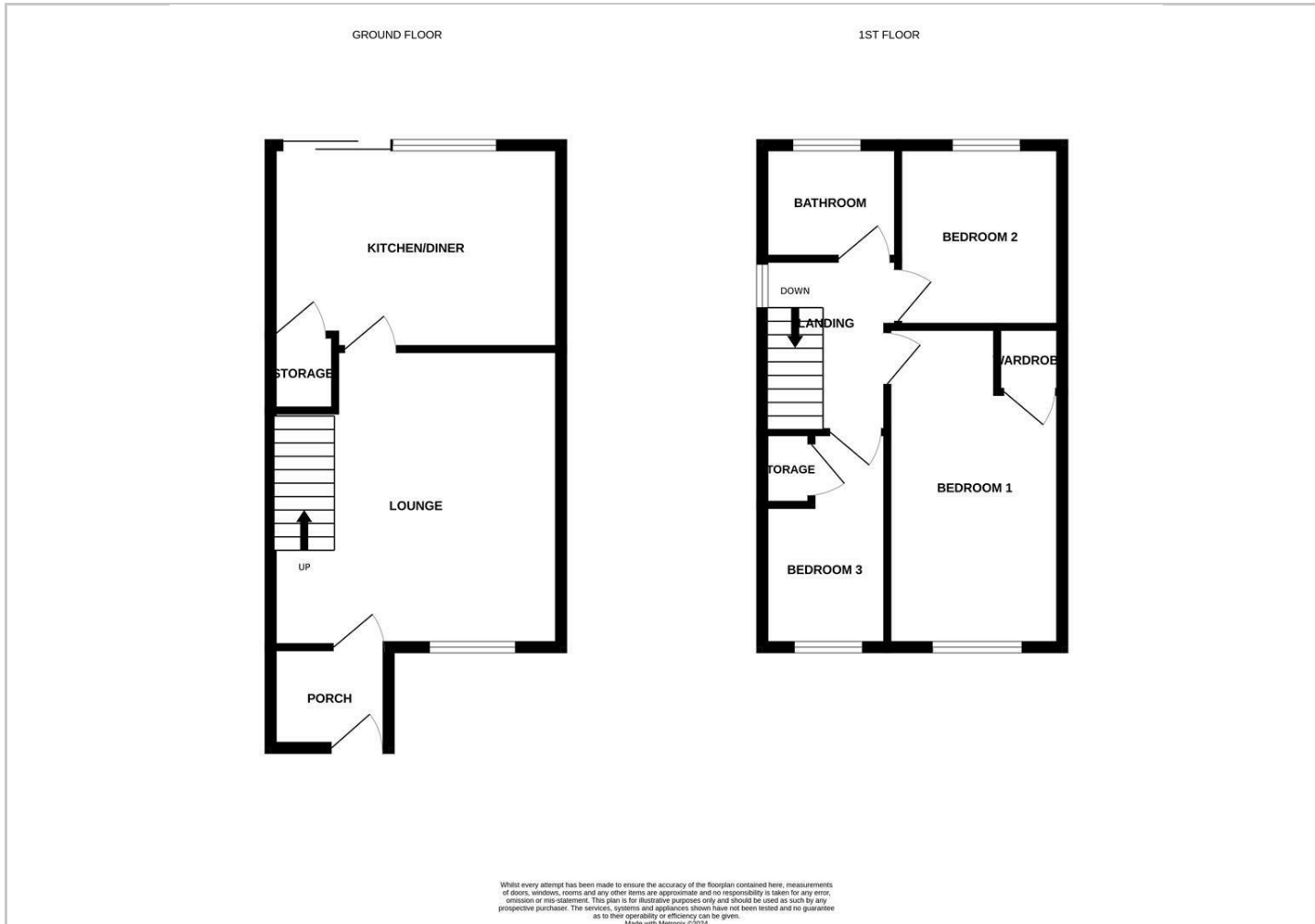

## Viewing

Please contact our Sandbach Office on 01270 353753 if you wish to arrange a viewing appointment for this property or require further information.

The particulars are set out as a general outline only for the guidance of intended purchasers or lessees, and do not constitute, any part of a contract. Nothing in these particulars shall be deemed to be a statement that the property is in good structural condition or otherwise nor that any of the services, appliances, equipment or facilities are in good working order. Purchasers should satisfy themselves of this prior to purchasing.

## Location Map

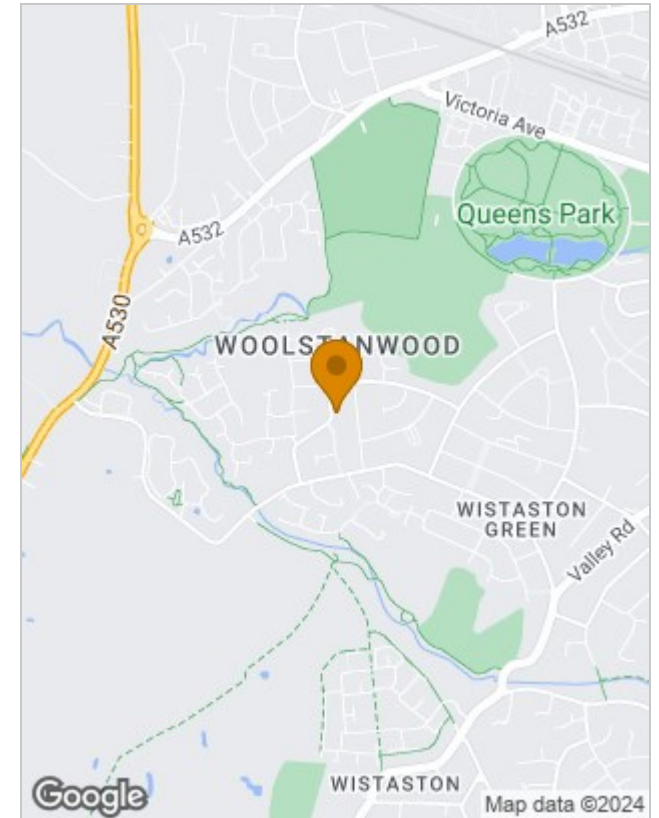

## Energy Performance Graph

