



PCM

£1,300

****AVAILABLE MID NOVEMBER****

This top floor, two double bedroom apartment is available on an un-furnished basis. The property is located on the west side of High Wycombe within walking distance of West Wycombe Village and just a short drive to junction 4 of the M40. The accommodation comprises; entrance porch, bright and spacious living room, newly fitted kitchen/diner, two double bedrooms (master with built in wardrobes) and newly fitted family bathroom. The property further benefits; gas central heating, UPVC double glazing, off street residents parking and communal gardens.

HOLDING FEE: £300

DEPOSIT REQUIRED: £1,500

TENANCY LENGTH: 12 MONTHS

- TWO DOUBLE BEDROOMS
- LARGE KITCHEN/DINER
- UPVC DOUBLE GLAZING
- COMMUNAL GARDENS
- UN-FURNISHED
- GAS CENTRAL HEATING
- MODERN BATHROOM
- OFF STREET PARKING
- AVAILABLE NOVEMBER
- CLOSE TO W.W VILLAGE



37 Rosemary Court Rosemary Close, High Wycombe, Bucks, HP12 4AG

Estate Agents ~ Lettings Agents ~ Valuers ~ Independent Mortgage Advisors

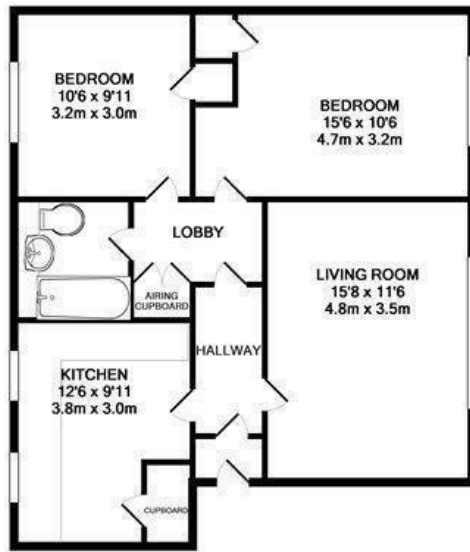

TOTAL APPROX. FLOOR AREA 699 SQ.FT. (64.9 SQ.M.)

Whilst every attempt has been made to ensure the accuracy of the floor plan contained here, measurements of doors, windows, rooms and any other items are approximate and no responsibility is taken for any error, omission, or mis-statement. This plan is for illustrative purposes only and should be used as such by any prospective purchaser. The services, systems and appliances shown have not been tested and no guarantee as to their operability or efficiency can be given.
Made with Metropix ©2014

