



£1,250 PCM *Unfurnished*

****AVAILABLE NOW****

This beautifully presented 3 bedroom cottage sits within Manor Road, Rowsham, a peaceful location, perfect for a family. This quaint unfurnished cottage features a private garage, providing convenient parking. The property further benefits from: UPVC Double Glazing, reception room, off street parking and a front and back garden.

TENANCY LENGTH: 12 MONTHS

DEPOSIT: £1,442.30

HOLDING FEE: £288.46

- AVAILABLE NOW
- COTTAGE
- GARAGE
- PRIVATE GARDEN
- 3 BEDROOMS
- UPVC DOUBLE GLAZING
- RECEPTION ROOM
- QUIET LOCATION



2 Yew Tree Cottages Manor Road, Rowsham, HP22 4QS

Estate Agents ~ Lettings Agents ~ Valuers ~ Independent Mortgage Advisors

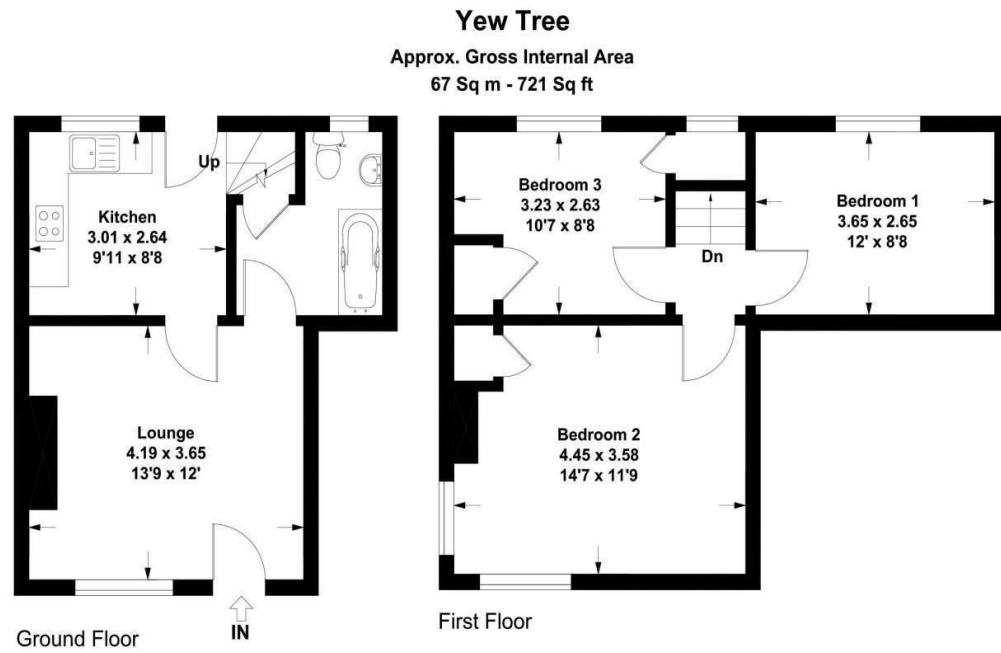

This floor plan is not to scale. It is for guidance only and accuracy is not guaranteed.

