



£1,200 PCM *Unfurnished*

****AVAILABLE LATE JUNE****

A bright and spacious, ground floor, two bedroom apartment located in a sought after modern development sides onto Aylesbury's Grand Union Canal, which is located within walking distance of Aylesbury's town centre and train station. The accommodation comprises; entrance hall, open plan lounge/kitchen/diner, two bedrooms, and family bathroom. The property also benefits from; off street residents parking (with visitors bays) and gas central heating.

HOLDING FEE: £276.92

DEPOSIT: £1,384.62

TENANCY LENGTH: 12 MONTHS

- AVAILABLE LATE JUNE
- GROUND FLOOR
- OPEN PLAN LIVING
- CLOSE TO TOWN
- UNFURNISHED
- TWO BEDROOMS
- ALLOCATED PARKING
- GAS CENTRAL HEATING
- COMMUNAL GARDENS



35 Florey Gardens, Aylesbury, HP20 1RW

Estate Agents ~ Lettings Agents ~ Valuers ~ Independent Mortgage Advisors

Florey Gardens, Aylesbury, HP20 1RW

Approx. Gross Internal Area
51 Sq m - 549 Sq ft

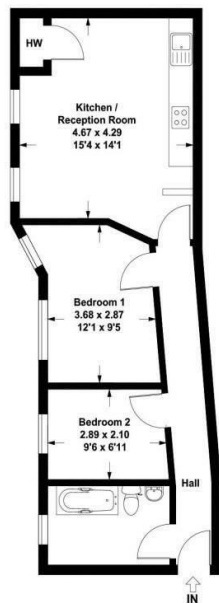

This floor plan is not to scale. It is for guidance only and accuracy is not guaranteed.

