



£1,000 PCM *Unfurnished*

****AVAILABLE EARLY AUGUST - UNFURNISHED****

A spacious and well presented, one bedroom first floor apartment conveniently situated in this sought after development in the centre of the town. The apartment is in a quiet mews, tucked away from the High Street and within walking distance of the railway station. The property comprises; entrance hall, lounge with feature fireplace, modern fitted kitchen with breakfast bar, double bedroom with fitted wardrobes, modern bathroom. The property also benefits from; gas central heating, UPVC double glazing and allocated parking for one vehicle.

HOLDING FEE: £230.77

DEPOSIT REQUIRED: £1,153.85

TENANCY LENGTH: 12 MONTHS MINIMUM

- AVAILABLE AUGUST
- KITCHEN/BREAKFAST
- FITTED WARDROBES
- GAS CENTRAL HEATING
- ALLOCATED PARKING
- LARGE LOUNGE
- DOUBLE BEDROOM
- MODERN BATHROOM
- UPVC DOUBLE GLAZING
- SUPERB LOCATION



8 Regent House Malthouse Square, Church Street, Princes Risborough,

Estate Agents ~ Lettings Agents ~ Valuers ~ Independent Mortgage Advisors

FIRST FLOOR
409 sq.ft. (38.0 sq.m.) approx.

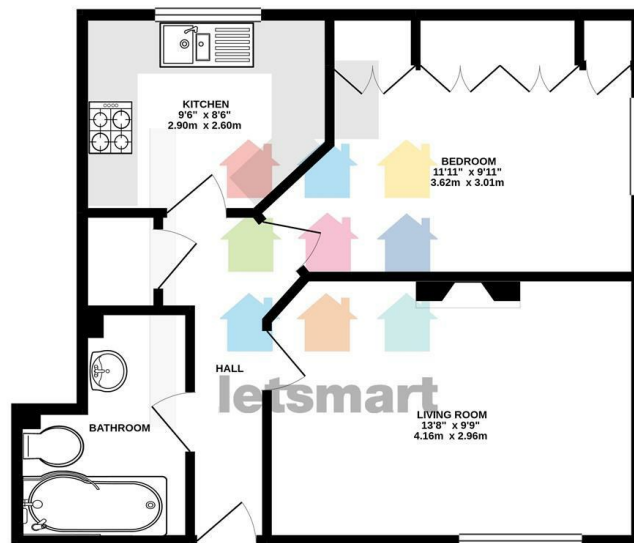

TOTAL FLOOR AREA: 409 sq.ft. (38.0 sq.m.) approx.
Whilst every effort has been made to ensure the accuracy of the floorplan contained herein, measurements of doors, windows, rooms and any other items are approximate and no responsibility is taken for any error, omission or mis-statement. This plan is for illustrative purposes only and should be used as such for any prospective purchaser. The services, systems and appliances shown have not been tested and no guarantee as to their operability or efficiency can be given.
Made with Metago ©2010

