



**£1,450 PCM**    *Unfurnished*

**\*\*AVAILABLE NOW\*\***

This two/three bedroom, three storey home situated in the popular area of Old Aylesbury. The accommodation comprises; entrance hall, third bedroom/study, open plan kitchen/living room/dining room, two double bedrooms and family bathroom. The property also benefits from; garage and driveway parking, UPVC double glazing and gas central heating.

HOLDING FEE: £334.62

DEPOSIT REQUIRED: £1,673.08

LENGTH OF TENANCY: 12 MONTHS

- AVAILABLE NOW
- GARAGE
- FULLY REDECORATED
- TOWN CENTRE
- GAS CENTRAL HEATING
- TWO/THREE BEDROOMS
- DRIVEWAY PARKING
- OLD AYLESBURY
- OPEN PLAN LIVING
- UPVC DOUBLE GLAZING



**1 Castle Court, Aylesbury, HP20 2RD**

Estate Agents ~ Lettings Agents ~ Valuers ~ Independent Mortgage Advisors

Approximate Gross Internal Area  
 Ground Floor = 34.0 sq m / 366 sq ft  
 First Floor = 35.6 sq m / 383 sq ft  
 Second Floor = 35.6 sq m / 383 sq ft  
 Total = 105.2 sq m / 1,132 sq ft



 = Reduced headroom below 1.5m / 5'0"

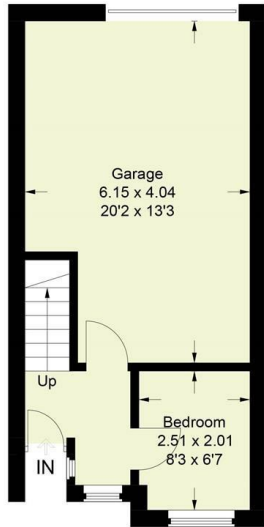

**Ground Floor**

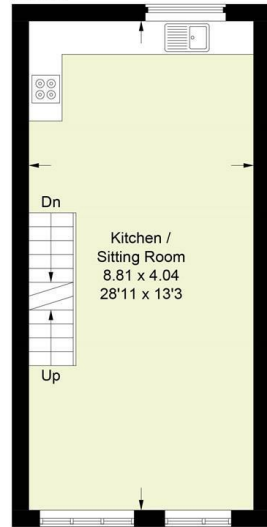

**First Floor**

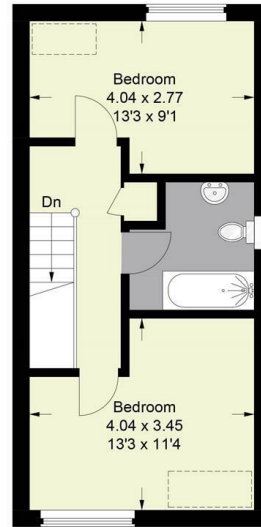

**Second Floor**

This plan is for layout guidance only. Not drawn to scale unless stated. Windows and door openings are approximate. Whilst every care is taken in the preparation of this plan, please check all dimensions, shapes and compass bearings before making any decisions reliant upon them.  
 © CJ Property Marketing Ltd Produced for Hurst

