

**£950 PCM**      *Unfurnished*

**\*\*AVAILABLE LATE JUNE\*\***

A ground floor, one double bedroom apartment located in a quiet residential area on the sought after Stoke Mandeville side of Aylesbury within close proximity to Stoke Mandeville Hospital. The accommodation comprises; entrance hall, lounge/ diner, modern fitted kitchen, double bedroom and bathroom. The property also benefits from; communal gardens, allocated parking, bike lockup area and UPVC double glazing.

HOLDING FEE: £219.23

DEPOSIT REQUIRED: £1,096.15

LENGTH OF TENANCY: 12 MONTHS

- AVAILABLE LATE JUNE
- GROUND FLOOR
- ALLOCATED PARKING
- OPEN PLAN KITCHEN
- DOUBLE BEDROOM
- CLOSE TO S.M HOSPITAL
- UNFURNISHED
- BUILT IN WARDROBES



**19 Chequers Court, Aylesbury, HP21 9EQ**

Estate Agents ~ Lettings Agents ~ Valuers ~ Independent Mortgage Advisors

### Chequers Court

Approx. Gross Internal Area

45 Sq m - 484 Sq ft

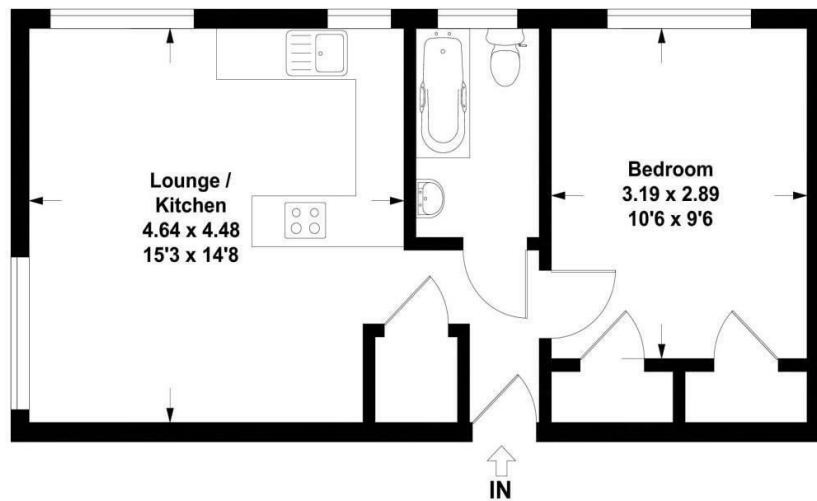

This floor plan is not to scale. It is for guidance only and accuracy is not guaranteed.