

# CHARTWAY STREET

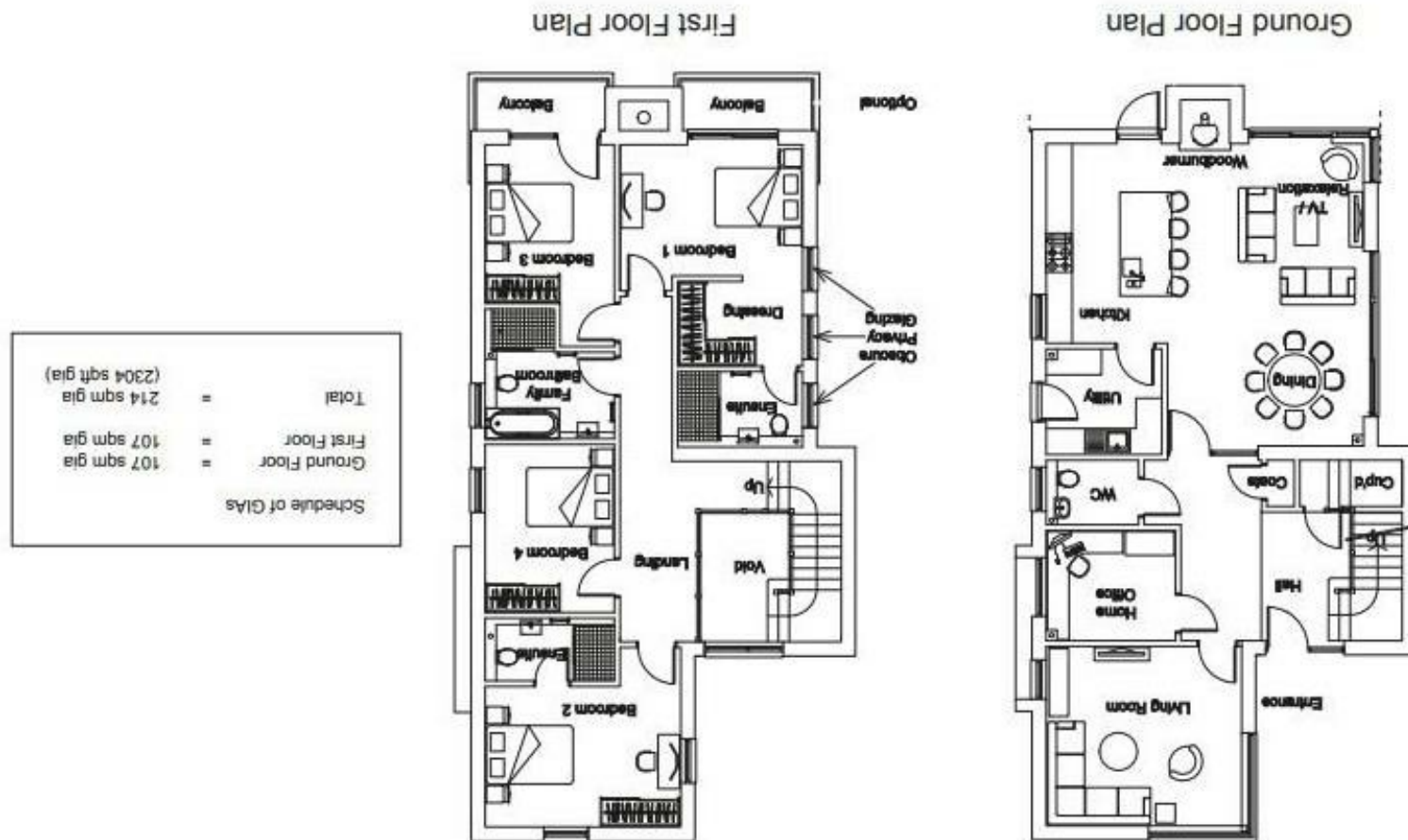

Chartway Street, ME17 3JA

Asking Price £850,000  
EPC RATING:





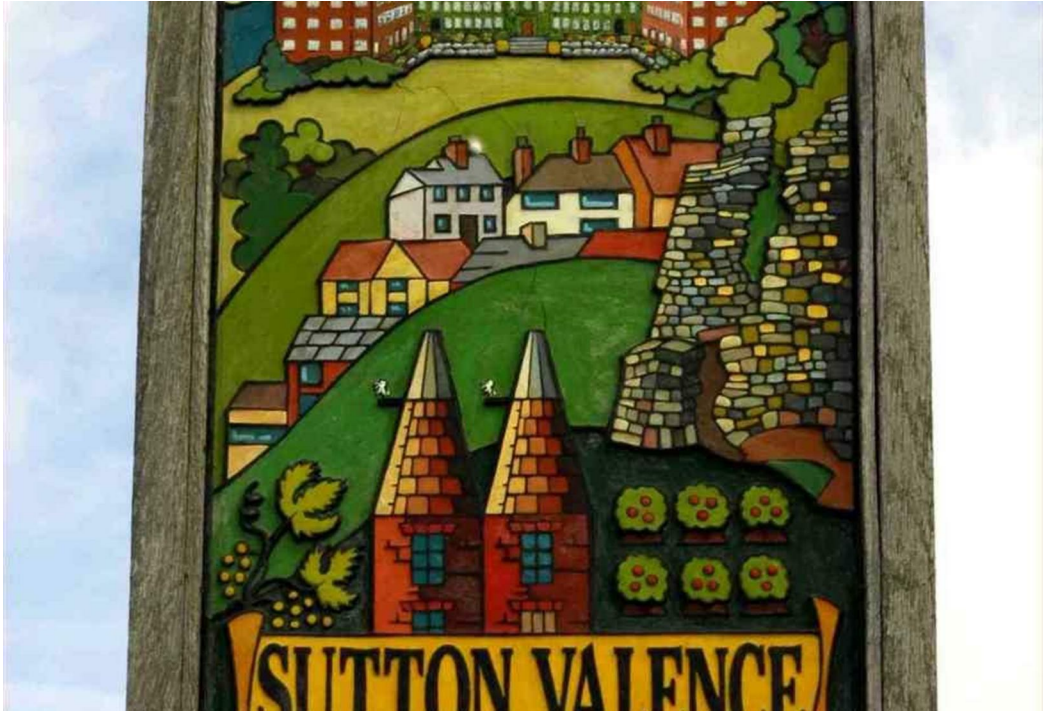

This is a wonderful opportunity to name & purchase a bespoke built luxury contemporary New Home, finished to your own specification\* in one of Sutton Valence's most desirable locations. Built by the Federation of Master Builders accredited Clark & Sons Construction to full "turn key" readiness, this bespoke home offers over 2,300 square feet of accommodation, including a generous open plan kitchen/dining/family room, home office and separate living room, with the four upstairs double bedrooms complemented by two en-suite bathrooms and a family bathroom.

The property will also offer two balconies overlooking the south facing landscaped\* gardens, with parking to the front for multiple cars.

Specifications can be adjusted to suit the individual including: kitchens, bathrooms, floor coverings, paint colour, in fact, everything\* can be customised to suit the buyer's requirements. (\*upgrades may incur additional costs)

Milestone staged payments – no requirement for full payment in advance

Funding options available

No Stamp Duty to pay, saving a typical buyer over £32,500 on an equivalent built home.

Can be fully landscaped\* to the buyers specification if required (\*at additional cost)

MATERIAL INFORMATION

Freehold  
Council Tax Band  
EPC Report



- No Stamp Duty to Pay • Beautiful Architect Designed Bespoke Home • Chance to Name & have built to your Own Specification • Over 2,300 Square Foot of Accommodation • Modern Contemporary Design • Ready to Move in Within 12 Months • Generous Well Planned Living Space • Four Large Double Bedrooms • Two En-Suites & Family Bathroom • Two South Facing Balconies

Agents Note: All dimensions are approximate and quoted for guidance only. Reference to appliances, fixtures, fittings and services does not imply that they are necessarily in good condition, fit the purpose or are in working order. Interested parties are advised to obtain verification from their Solicitors as to the Freehold/Leasehold status of the property and confirmation regarding the condition of any fixtures and fittings included in the sale.

11, COLMAN HOUSE, MAIDSTONE, KENT, ME14 1DJ | 01622 691255 | MAIDSTONESALES@SIMONMILLER.CO.UK