

The logo for Vizors estate agents, featuring a red circle with a white 'V' followed by the word 'izors' in a dark blue, sans-serif font. Below 'izors' is the text 'estate agents' in a smaller, lighter blue font.

vizors
estate agents



110 HEATHFIELD ROAD, REDDITCH, B97 5RD
OFFERS OVER £280,000

The logo for Vizors estate agents, featuring a red circle with a white 'V' followed by the word 'izors' in a dark blue, sans-serif font. Below 'izors' is the text 'estate agents' in a smaller, lighter blue font.

vizors
estate agents

WITH OFF ROAD PARKING TO THE REAR - Set in the highly desirable district of Webeath and located on the edge of courtside walks close to your door step is this beautifully presented traditional three bedroom semi-detached home has been impeccably updated and maintained by the current owners and must be seen to appreciate the overall accommodation on offer.

This stunning home offers; living room with log burner fire feature, modern fitted kitchen opening to the diner, ground floor guest WC, two double bedrooms, a further single bedroom and impressive modern bathroom which has been finished to an excellent standard.

Outside is a generous rear garden which offers a decked patio area, further patio space lower down and a grassed area with some boarders which leads to shed storage at the rear with the access gate leading to ample off road parking which is accessed via a small, tucked away service road.

The property sits only a road away from the highly requested Webheath First School. Within the immediate area of the property is a post office/local convenience store, Biddles shop, Rose & Crown Public House, Dental surgeries and a play ground. The property is also conveniently located to the Bromsgrove Highway providing access into Bromsgrove and Redditch within a few minutes drive along with easy access to motorways in the surrounding area.

Council Tax Band- C (Redditch).

EPC Rating - D

Tenure- Freehold (awaiting solicitor confirmation).



Approach

A stone chipped parking area at the rear, rear gate access via the rear garden. At the front, pathway via fore garden to main front entrance via;



Hallway

Stairs off to the first floor landing, door into;

Living Room

13'1" max x 13'1" max (4.00m max x 4.00m max)

With door into;



Kitchen Diner

16'0" max x 13'5" max (4.90m max x 4.10m max)

With doors leading out to the rear garden. Kitchen area is semi-open plan to the dining room/area.



Landing

Leads off to;

Bedroom One

12'6" max x 11'0" max (3.82m max x 3.36m max)



Bedroom Two

10'11" max x 10'5" max (3.35m max x 3.20m max)



Bedroom Three

9'6" max x 6'6" max (2.90m max x 2.00m max)



Bathroom

7'10" max x 5'10" max (2.40m max x 1.80m max)





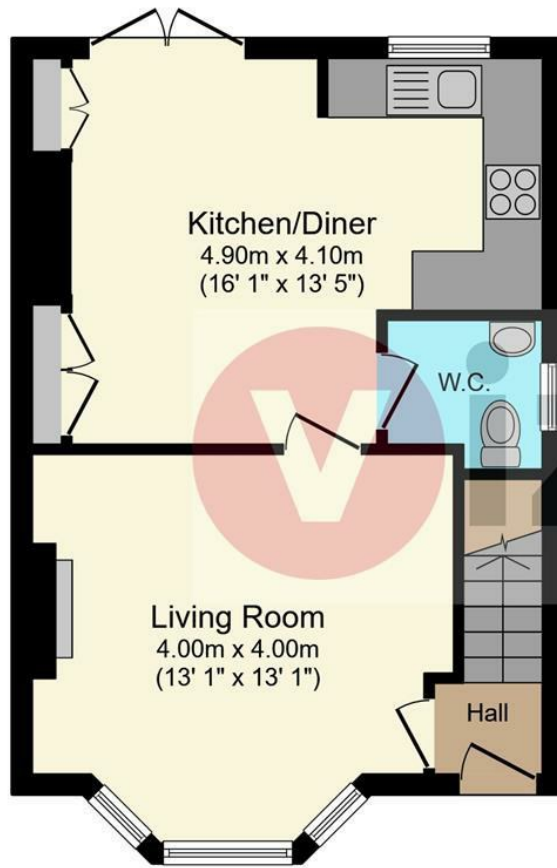

Ground Floor

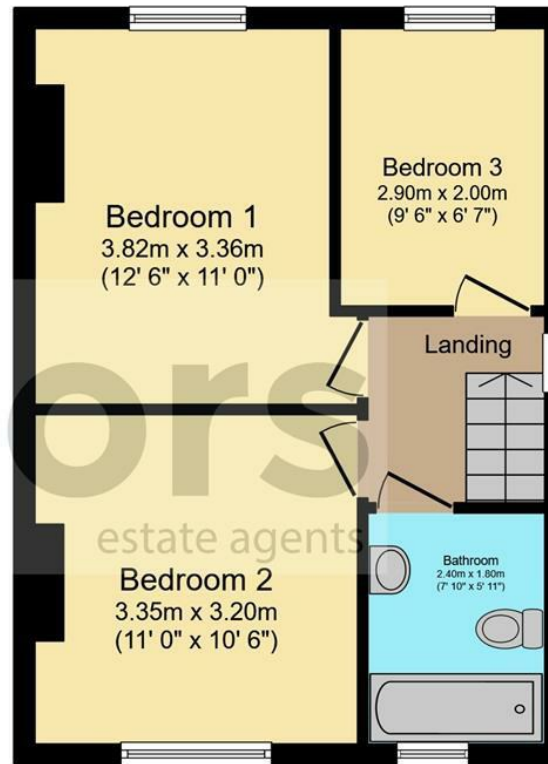

First Floor

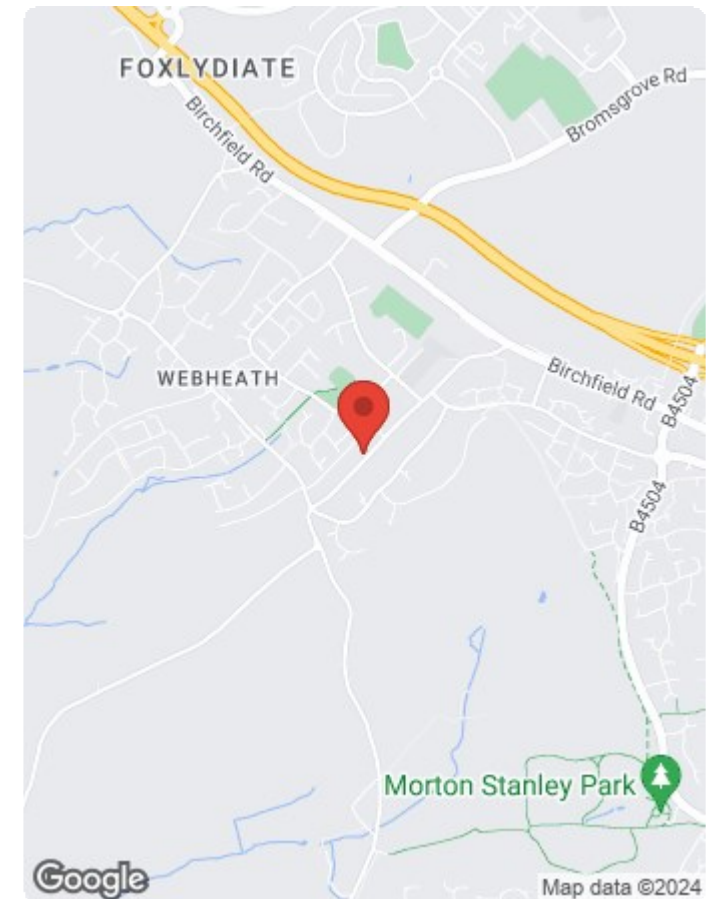

This floor plan is for illustrative purposes only. It is not drawn to scale. Any measurements, floor areas (including any total floor area), openings and orientation are approximate. No details are guaranteed, they cannot be relied upon for any purpose and they do not form part of any agreement. No liability is taken for any error, omission or misstatement. A party must rely upon its own inspection(s). Plan produced for Vizors. Powered by www.focalagent.com

Energy Efficiency Rating		Current	Potential
Very energy efficient - lower running costs			
(92 plus) A			89
(81-91) B			
(69-80) C			
(55-68) D		67	
(39-54) E			
(21-38) F			
(1-20) G			
Not energy efficient - higher running costs			
England & Wales		EU Directive 2002/91/EC	

Environmental Impact (CO ₂) Rating		Current	Potential
Very environmentally friendly - lower CO ₂ emissions			
(92 plus) A			89
(81-91) B			
(69-80) C			
(55-68) D			
(39-54) E			
(21-38) F			
(1-20) G			
Not environmentally friendly - higher CO ₂ emissions			
England & Wales		EU Directive 2002/91/EC	



Vizor Estate Agents Ltd
Company No. 7848499



Hyde House, 52 Bromsgrove Road, Redditch, B97 4RJ

Tel: 01527 584 533 www.vizorestates.com