



**HUNTERS**<sup>®</sup>

HERE TO GET *you* THERE

16 Dunmore Street, Bristol, BS4 2BQ

16 Dunmore Street, Bristol, BS4 2BQ

£350,000

Nestled in the heart of Totterdown on Dunmore Street, this charming terraced house presents an excellent opportunity for those seeking a comfortable and convenient home. The well-appointed kitchen diner is perfect for family meals and social gatherings, providing a warm and welcoming atmosphere.

Situated in a popular location, this home is close to local amenities. Additionally, excellent transport links are nearby, providing easy access to the wider Bristol area and beyond. This property is 0.6 miles walking distance from Temple Meads Station and 1 mile walking distance from the City Centre.

The house features two bedrooms, ideal for a small family or professionals looking for extra space. The bathroom is conveniently located upstairs, ensuring ease of access.

This terraced house on Dunmore Street is a wonderful blend of comfort, convenience, and charm, making it an ideal choice for anyone looking to settle in this vibrant part of Bristol.

Don't miss your opportunity to view this beautiful home, Contact us today on 0117 972 3948 or [Knowle.bristol@hunters.com](mailto:Knowle.bristol@hunters.com)

Hunters Knowle (Bristol) 308 Wells Road, Knowle, Bristol BS4 2QG | 0117 972 3948  
[knowle.bristol@hunters.com](mailto:knowle.bristol@hunters.com) | [www.hunters.com](http://www.hunters.com)



GROUND FLOOR  
371 sq.ft. (34.5 sq.m.) approx.



1ST FLOOR  
282 sq.ft. (26.2 sq.m.) approx.

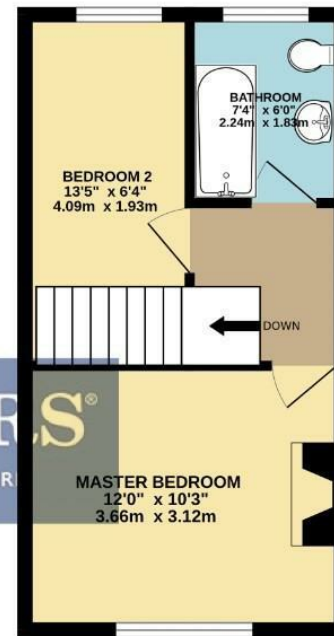

TOTAL FLOOR AREA : 667sq.ft. (62.0 sq.m.) approx.

Whilst every attempt has been made to ensure the accuracy of the floorplan contained here, measurements of doors, windows, rooms and any other items are approximate and no responsibility is taken for any error, omission or mis-statement. This plan is for illustrative purposes only and should be used as such by any prospective purchaser. The services, systems and appliances shown have not been tested and no guarantee as to their operability or efficiency can be given.  
Made with Metropack C2025

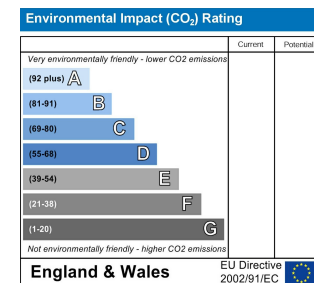
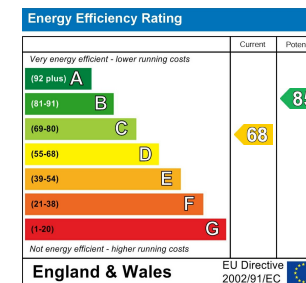

**Entrance Hall**

Entrance door to front elevation, Stairs to first floor,  
Doors to rooms. wood floors

**Lounge**

Double glazed window to front elevation, Chimney  
breast, log burner, Radiator. wood floors

**Kitchen/Diner**

Double glazed window to rear elevation, Double glazed  
door to rear elevation, Range of wall and base units with  
workspaces above, Sink drainer, Space for range cooker,  
Space for upright fridge freezer, Plumbing for washing  
machine, Chimney breast, Built in storage cupboard.  
wood floors

**Landing**

Doors to bedrooms. wood floors

**Bedroom One**

Double glazed window to front elevation, Chimney  
breast, Fireplace with mantle surround, Radiator. Wood  
floors

**Bedroom Two**

Double glazed window to rear elevation, Built in storage  
cupboard, Radiator. Wood floors

**Bathroom**

Double glazed window to rear elevation, Low level WC,  
Wash hand basin, Panelled bath with shower over,  
Radiator.

**Rear Garden**

Enclosed via hedges and brick walls, Concrete area,  
Flower borders.

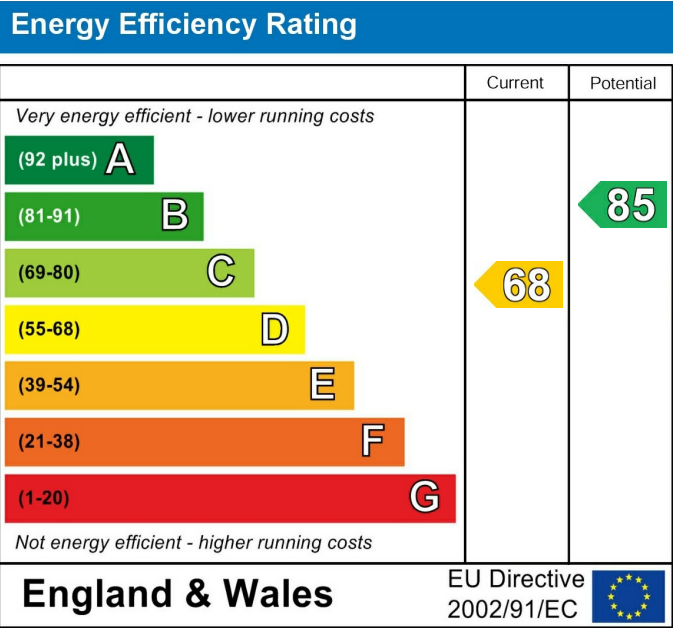

These particulars are intended to give a fair and reliable description of the property but no responsibility for any inaccuracy or error can be accepted and do not constitute an offer or contract. We have not tested any services or appliances (including central heating if fitted) referred to in these particulars and the purchasers are advised to satisfy themselves as to the working order and condition. If a property is unoccupied at any time there may be reconnection charges for any switched off/disconnected or drained services or appliances - All measurements are approximate. If you are thinking of selling your home or just curious to discover the value of your property, Hunters would be pleased to provide free, no obligation sales and marketing advice. Even if your home is outside the area covered by our local offices we can arrange a Market Appraisal through our national network of Hunters estate agents.















