



HUNTERS[®]
HERE TO GET *you* THERE

Beckington Walk, Bristol, BS3 5EA

3 Beckington Walk, Bristol, BS3 5EA

Offers In Excess Of £450,000

A superb 1930s semi detached home sitting tucked away in a desirable family spot

Hunters Knowle (Bristol) 308 Wells Road, Knowle, Bristol BS4 2QG | 0117 972 3948
knowle.bristol@hunters.com | www.hunters.com

GROUND FLOOR
531 sq.ft. (49.3 sq.m.) approx.



1ST FLOOR
415 sq.ft. (38.6 sq.m.) approx.

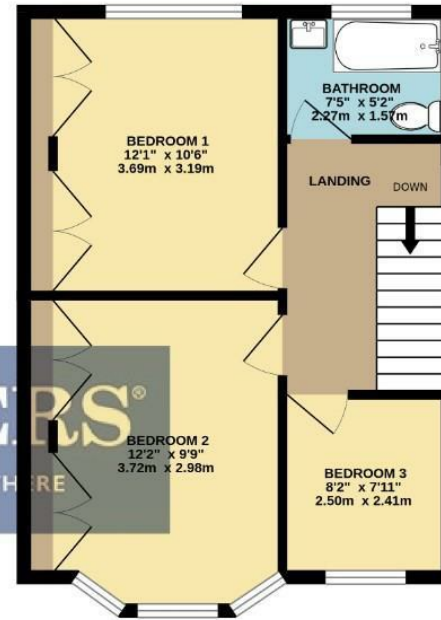

TOTAL FLOOR AREA : 946 sq.ft. (87.9 sq.m.) approx.

Whilst every attempt has been made to ensure the accuracy of the floorplan contained here, measurements of doors, windows, rooms and any other items are approximate and no responsibility is taken for any error, omission or mis-statement. This plan is for illustrative purposes only and should be used as such by any prospective purchaser. The services, systems and appliances shown have not been tested and no guarantee as to their operability or efficiency can be given.
Made with Metrix 50204.

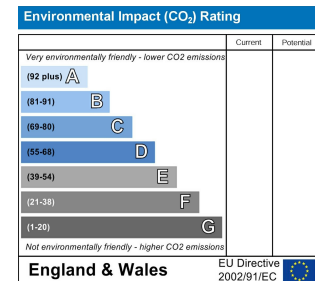
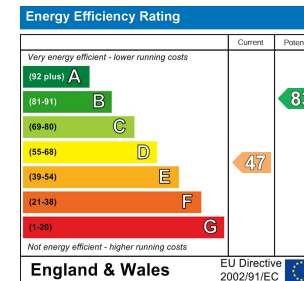

living room

13'2" x 12'4"

dining room

12'1" x 11'7"

conservatory

10'2" x 9'0"

kitchen

11'11" x 7'5"

bedroom one

12'1" x 10'5"

bedroom two

12'2" x 9'9"

bedroom three

8'2" x 7'10"

bathroom

7'5" x 5'1"

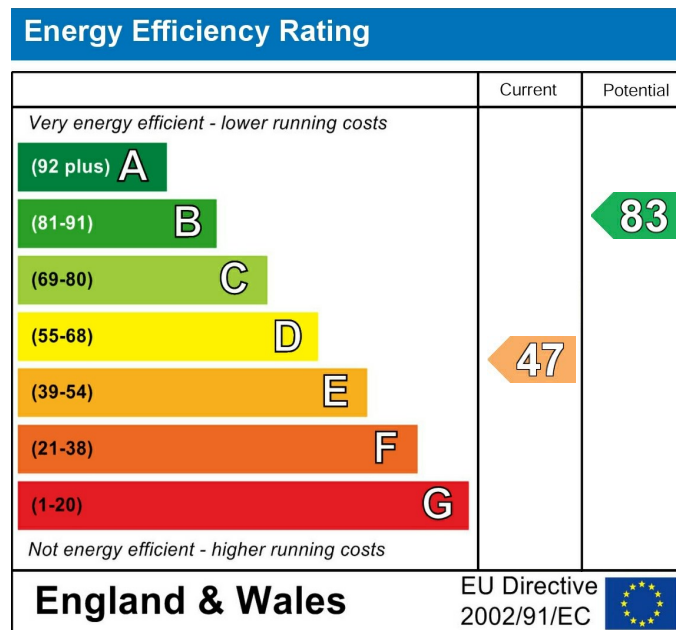

These particulars are intended to give a fair and reliable description of the property but no responsibility for any inaccuracy or error can be accepted and do not constitute an offer or contract. We have not tested any services or appliances (including central heating if fitted) referred to in these particulars and the purchasers are advised to satisfy themselves as to the working order and condition. If a property is unoccupied at any time there may be reconnection charges for any switched off/disconnected or drained services or appliances - All measurements are approximate. If you are thinking of selling your home or just curious to discover the value of your property, Hunters would be pleased to provide free, no obligation sales and marketing advice. Even if your home is outside the area covered by our local offices we can arrange a Market Appraisal through our national network of Hunters estate agents.



