



Allan Morris
estate agents

 **MAYFAIR**
OFFICE GROUP

Flat B, 12 Bath Road, Worcester. WR5 3EJ

Offers In Region Of £165,000

🛏 2 🍳 1 🚿 1



A very well presented and deceptively spacious two bedroom Apartment, situated within this sought after area, within walking distance of the city, local amenities and major transport links.

Accommodation briefly comprises: Secure entry and steps to lower ground floor, giving access into: Entrance Hall, good size Sitting Room/Dining Area, Kitchen, two double Bedrooms and Bathroom.

Outside:

Communal parking available on a first come, first serve basis.

LOCATION:

The property is centrally located within easy reach of the city, major transport links, including railway stations, motorway links and full range of all local amenities and schooling.

Sitting Room: - 4.5m x 3.5m (14'9" x 11'5")

Kitchen: - 3.5m x 2.9m (11'5" x 9'6")

Bedroom 1: - 3.9m x 3.2m (12'9" x 10'5")

Bedroom 2: - 3.9m x 2.7m (12'9" x 8'10")

Bathroom: - 2.4m x 2m (7'10" x 6'6")



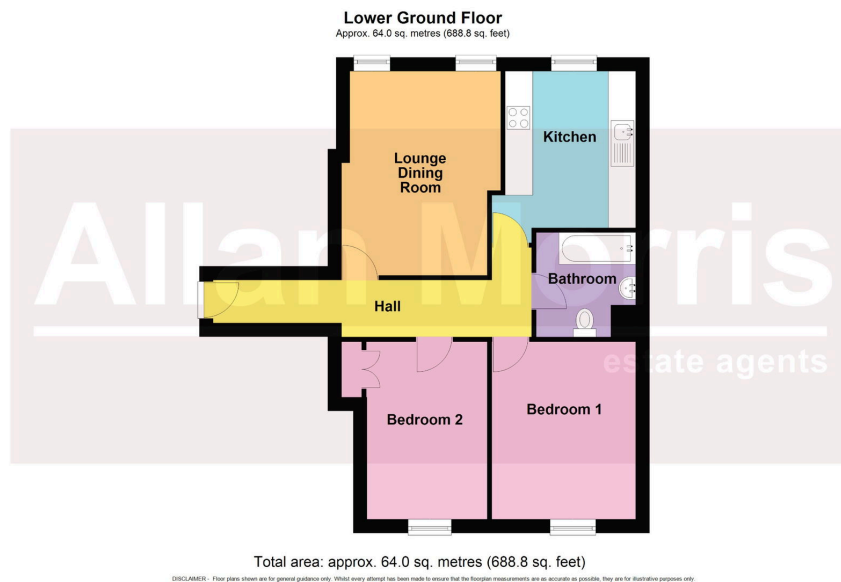

- 2 Spacious Bedrooms
- Kitchen and Bathroom
- Close to all amenities & major transport links
- Council Tax Band: B
- Large Sitting Room/Dining Area
- Walking distance of city centre
- Communal parking available

