



Allan Morris
estate agents

 **MAYFAIR**
OFFICE GROUP

1 Harkaway Cottages, Whittington, Worcester. WR5 2RP

Guide Price £425,000

3 1 2



A charming and characterful semi detached Cottage, offering well proportioned and superbly presented accommodation, situated on the outskirts of Whittington, with a generous mature private garden and off road parking. The location provides easy access to Worcester, national road and rail networks.

Accommodation briefly comprises: Entrance Hall, Lounge, Dining Room, Kitchen (refitted), three Bedrooms, Family Bathroom and Attic Room.

Outside:

To the front of the property is a lawned foregarden, with shrub beds and borders. To the side of the property is a gravelled driveway providing off road parking for up to 4 cars, in turn giving access to the rear garden. To the rear of the property is a generous private mature garden, predominantly laid to lawn, with shrub beds and borders, paved patio area, outside cold water tap and an oil storage tank.

Kitchen - 3.41m x 2.38m (11'2" x 7'9")

Dining Room - 3.45m x 4.66m (11'3" x 15'3")

Lounge - 3.4m x 4.45m (11'1" x 14'7")

Bedroom 1 - 3.5m x 3.56m (11'5" x 11'8")

Bedroom 2 - 3.35m x 3.56m (10'11" x 11'8")

Bedroom 3 - 2.06m x 2.38m (6'9" x 7'9")

Bathroom - 2.55m x 1.77m (8'4" x 5'9")

Attic Room - 4.47m x 5.43m (14'7" x 17'9")



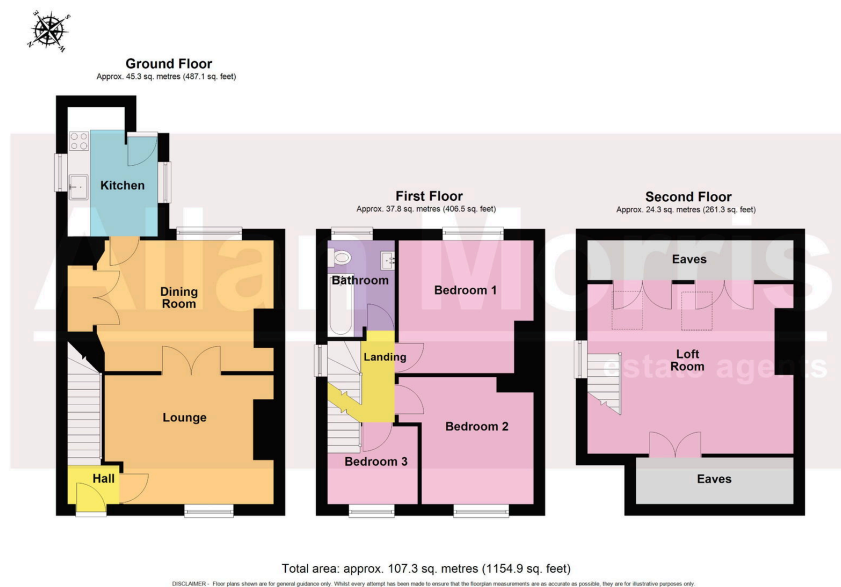

- Charming and characterful semi detached home
- Off road parking for up to 4 cars
- Oil fire central heating & double glazing
- Viewing highly recommended
- Generous private mature gardens
- Refitted Kitchen
- Convenient location
- Council Tax Band: C

