



Allan Morris
estate agents

 **MAYFAIR**
OFFICE GROUP

Apartment 2a, Bevere House, Bevere Green, Bevere, Worcester. WR3 7RG

Offers Over £200,000

🛏 1 🚿 1 🚿 1



A beautifully refurbished one bedroom ground floor Apartment, finished to a very high standard, forming part of the historic, Grade II Listed, Bevere House.

Accessed off well maintained communal areas, the Apartment benefits from: Entrance Hall, spacious Lounge/Diner, refitted Kitchen, double Bedroom and refitted Bathroom.

Outside: There is the benefit of communal parking, En-bloc single Garage and stunning, well kept, communal gardens, boasting a number of mature trees and shrubs.

LOCATION:

The property is located in the glorious Bevere Green area of Worcester, offering a great mix of rural living, yet convenient for easy access back to Worcester City centre and motorway links, also wonderful countryside and riverside walks in reach.

Garage: - 5.51m x 2.72m (18'1" x 8'11")

Lounge / Diner: - 5.92m x 3.56m (19'5" x 11'8")

Kitchen: - 3.23m x 2.87m (10'7" x 9'5")

Bedroom 1: - 3.76m x 2.95m (12'4" x 9'8")

Bathroom: - 2.87m maximum x 1.47m (9'5" maximum x 4'10")



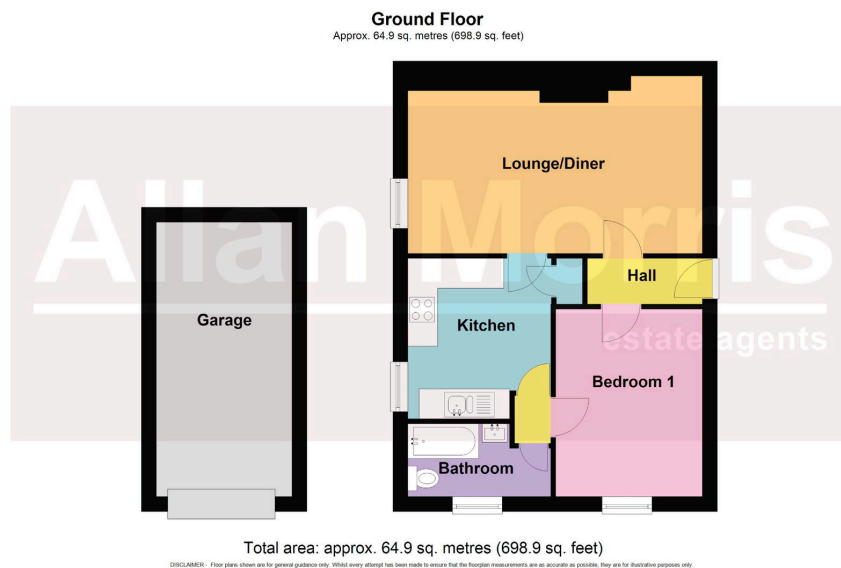

- Ground floor Apartment
- 1 Double Bedroom
- Communal Parking
- Stunning location
- Refurbished throughout
- Grade II Listed
- Single Garage
- NO ONWARD CHAIN

