



Allan Morris
estate agents

 **MAYFAIR**
OFFICE GROUP

17 Quebec Close, Lower Wick, Worcester. WR2 4DY
£390,000

4 1 2



A wonderful opportunity to acquire an extended four bedroom detached property, sat within this corner plot in a quiet cul-de-sac location.

Accommodation briefly comprises: Entrance Hall with W.C. off, Kitchen, large Living Room, Dining and Conservatory. On the first floor: Three double Bedrooms (all with integral wardrobes), further Bedroom with integral storage and Shower Room.

Outside: The property benefits from off road parking for several vehicles, further paved potential parking area, single Garage, wrap around plot and pleasant well stocked rear garden, with mature shrub and hedge borders.

LOCATION:

The property is situated in the ever popular area of Lower Wick, offering easy access to local schooling, amenities, bus routes and major transport links.

Living Room: - 5.67m x 4.56m (18'7" x 14'11")

Dining Room: - 3.78m x 3.28m (12'5" x 10'9")

Kitchen: - 2.95m x 2.54m (9'8" x 8'4")

Conservatory: - 4.47m x 2.74m (14'8" x 9'0")

Bedroom 1: - 3.78m x 3.28m (12'5" x 10'9")

Bedroom 2: - 3.66m x 2.95m (12'0" x 9'8")

Bedroom 3: - 3.45m x 2.95m (11'4" x 9'8")

Bedroom 4: - 2.62m x 2.46m (8'7" x 8'1")

Garage: - 5.92m x 2.51m (19'5" x 8'3")



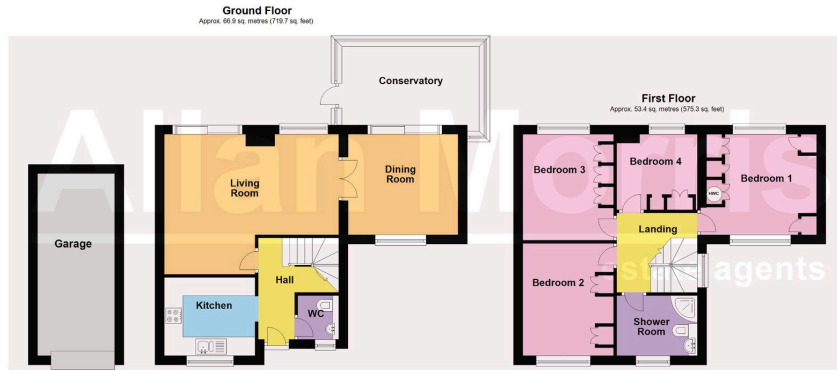

Total area: approx. 120.3 sq. metres (1295.0 sq. feet)

DISCLAIMER - Floor plans shown are for general guidance only. Whilst every attempt has been made to ensure that the floorplan measurements are as accurate as possible, they are for illustrative purposes only.



- NO ONWARD CHAIN
- 4 Bedrooms
- Further potential
- Garage
- Extended
- 2 Reception Rooms
- Landscaped garden
- Cul-de-sac location

