



Allan Morris
estate agents

 **MAYFAIR**
OFFICE GROUP

5 King Charles Place, St. John's, Worcester. WR2 5AJ

£110,000

🛏️ 2 🚿 1 🚗 1



A refurbished two bedroom Apartment, situated to the west of Worcester City within the suburb of St. John's.

Accommodation comprising: Communal Entrance, Private Reception Hall, open plan Kitchen/Dining Area and Sitting Room, two Bedrooms and Bathroom.

Outside: The Apartment benefits from a balcony and is set within the King Charles place courtyard.

Sitting Room - 3.96m x 3.62m (12'11" x 11'10")

Kitchen/Diner - 3.96m x 3.1m (12'11" x 10'2")

Bedroom 1 - 3.64m x 2.43m (11'11" x 7'11")

Bedroom 2 - 2.77m x 2.58m (9'1" x 8'5")

Bathroom - 3.09m x 1.74m (10'1" x 5'8")



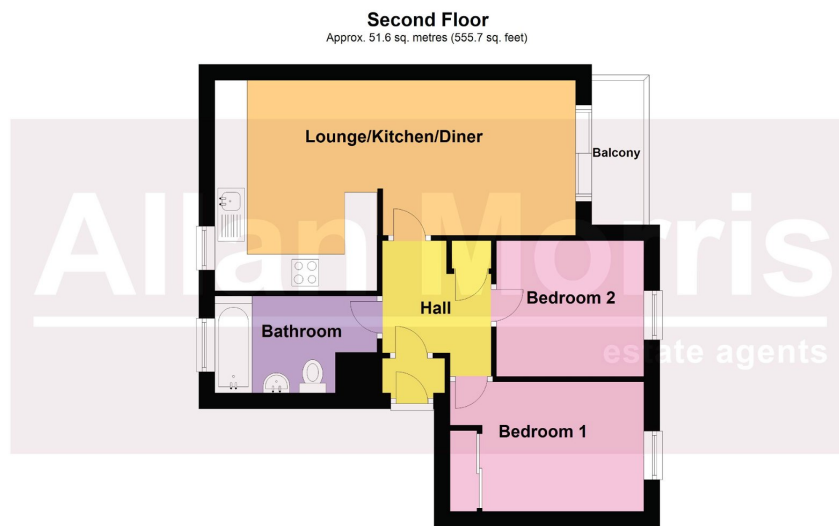

Total area: approx. 51.6 sq. metres (555.7 sq. feet)

DISCLAIMER - Floor plans shown are for general guidance only. Whilst every attempt has been made to ensure that the floorplan measurements are as accurate as possible, they are for illustrative purposes only.



- Cash Buyers Only
- Modern 2nd floor Apartment
- Open plan Kitchen/Dining Area/Sitting Room
- 2 Bedrooms
- Re-fitted Kitchen & Bathroom
- Double glazing & gas fired central heating
- Close to all local amenities
- Council Tax Band A

