



**Allan Morris**  
estate agents

 **MAYFAIR**  
OFFICE GROUP

# Garden Cottage, Jury Lane, Martley, Worcester. WR6 6PE

£525,000

🛏️ 3 🪑 2 🚗 1



A fabulous, individual modern detached three bedroom home enjoying a generous plot, situated along a quiet lane within the popular village of Martley.

Accommodation comprising: Entrance Hall, downstairs Cloakroom, Kitchen/Diner with Plant Room off and Living Room. On the first floor: Master Bedroom with En-Suite Shower Room, two further Bedrooms and a Family Bathroom.

Outside: To the front is a private driveway. To the rear is a most generous private garden offering a great degree of privacy.

#### LOCATION:

'Garden Cottage' is situated within the sought after village of Martley, offering local amenities and excellent schooling, with the Chantry High School close by, together with easy access into Worcester City and major transport links.



**Living Room** - 6.3m x 3.4m (20'8" x 11'2")

**Kitchen/Diner** - 5.38m x 3.07m (17'8" x 10'1")

**Bedroom 1** - 3.68m x 3.4m (12'1" x 11'2")

**En-suite** - 2.62m x 1.6m (8'7" x 5'3")

**Bedroom 2** - 3.07m x 2.74m (10'1" x 9'0")

**Bedroom 3** - 3.07m x 2.54m (10'1" x 8'4")

**Bathroom** - 2.84m x 1.6m (9'4" x 5'3")



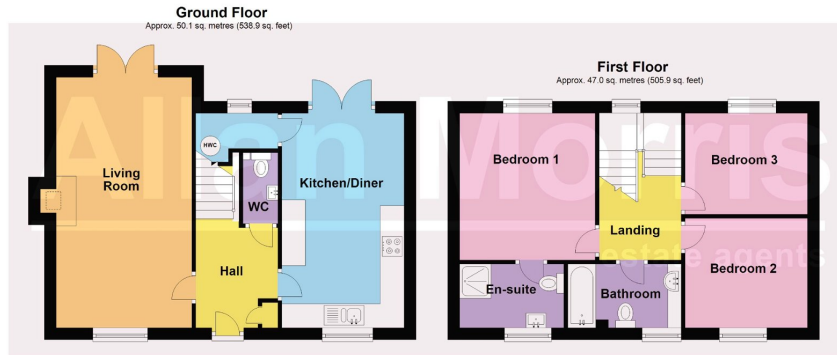

Total area: approx. 97.1 sq. metres (1044.8 sq. feet)

DISCLAIMER - Floor plans shown are for general guidance only. Whilst every attempt has been made to ensure that the floorplan measurements are as accurate as possible, they are for illustrative purposes only.



- Individual detached 3 bedroom house
- Generous driveway & fabulous private garden
- Aluminium windows & French doors
- EV car charging point
- No Onward Chain
- Spacious Kitchen/Diner & Living Room
- Underfloor heating & Airsource heat pump
- Coated aluminium gutters & downpipe
- Village location
- Council Tax Band

