



Colville Gardens, W11

£325,000



- One Double Bedroom
- Chain Free
- Porter
- Third Floor Flat
- Leasehold
- Lift

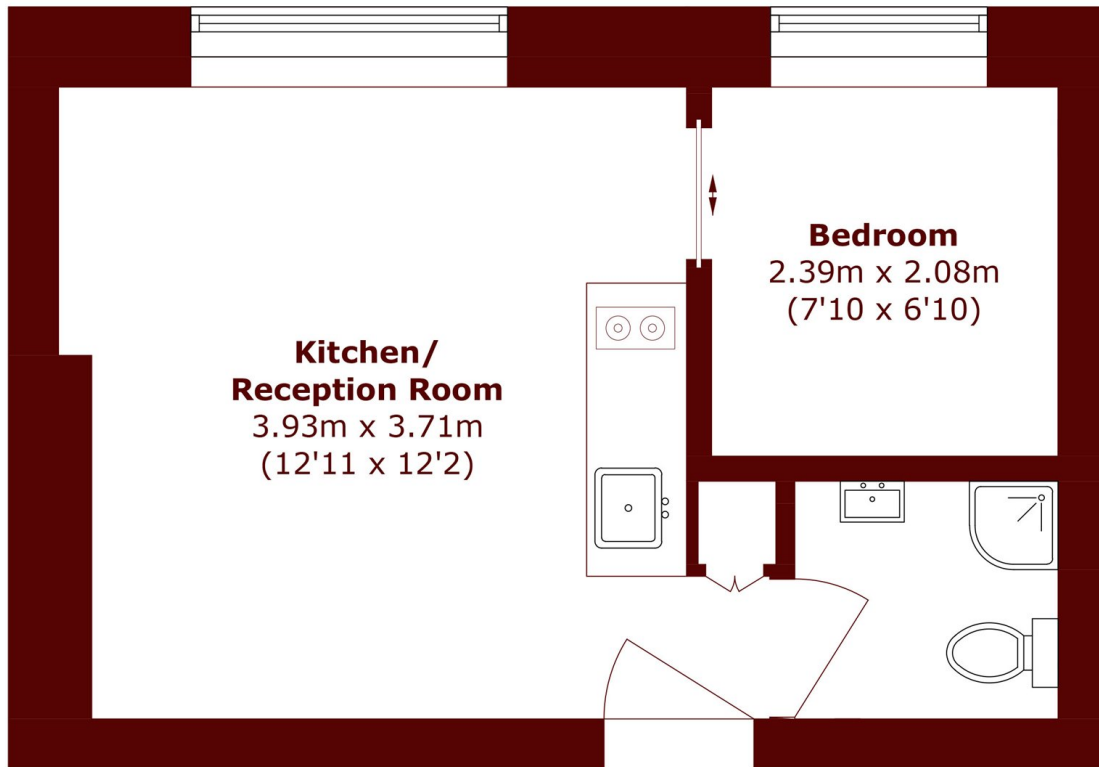

Third Floor

Total area (approx.): 23.8 sq. m (256.1 sq. ft)

Marsh & Parsons Notting Hill

2-6 Kensington Park Road,
London, W11 3BU
020 7313 2890