



Kildare Court, W2

£1,195,000



- Allocated Private Garage
- No Onward Chain
- Open Plan Kitchen
- Two Double Bedroom
- Duplex Apartment
- Quiet Street

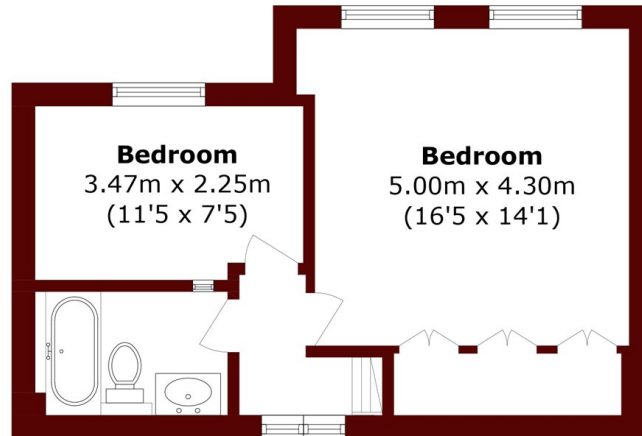

Fourth Floor



Third Floor

Total area (approx.): 70.0 sq. m (753.4 sq. ft)

Marsh & Parsons Notting Hill

2-6 Kensington Park Road,
London, W11 3BU
020 7313 2890