



Chepstow Villas, W11

£1,095 per week (£4,745 pcm)



- Three Bedrooms
- Natural Light

- Fully fitted Kitchen
- South facing Garden

- Bright Reception Room
- Envious Location

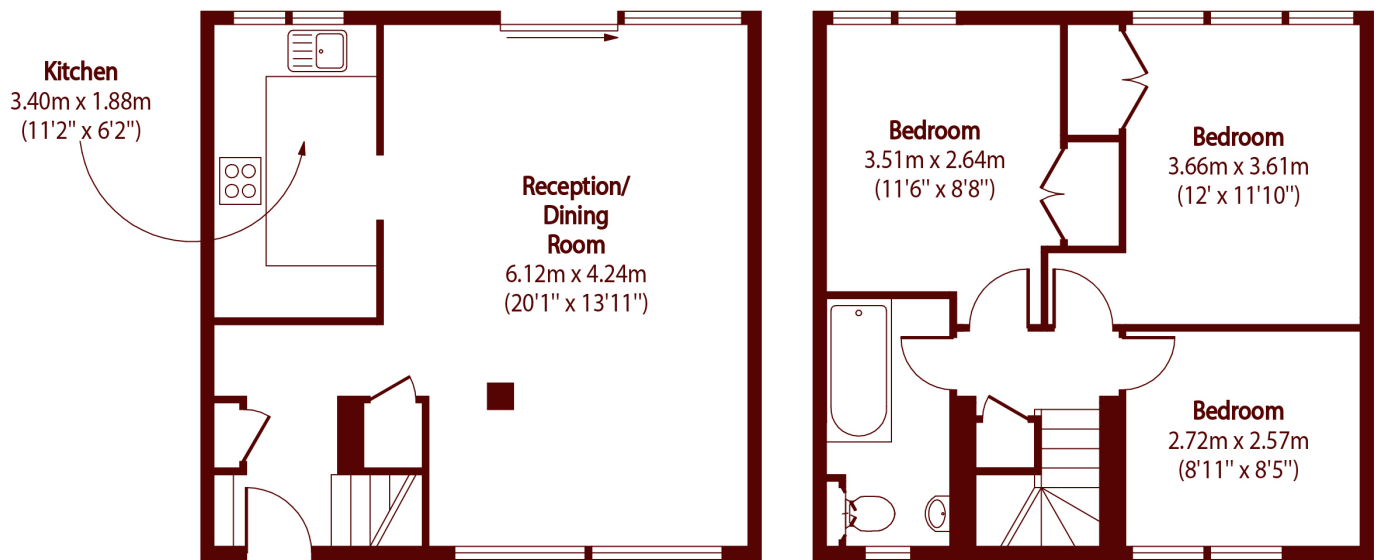

Total area (approx): 76.18 sq m (820 sq. ft)

Marsh & Parsons Notting Hill

2-6 Kensington Park Road,
London, W11 3BU
020 7313 2890