

## Chepstow Road, W2

£600 per week (£2,708 pcm)

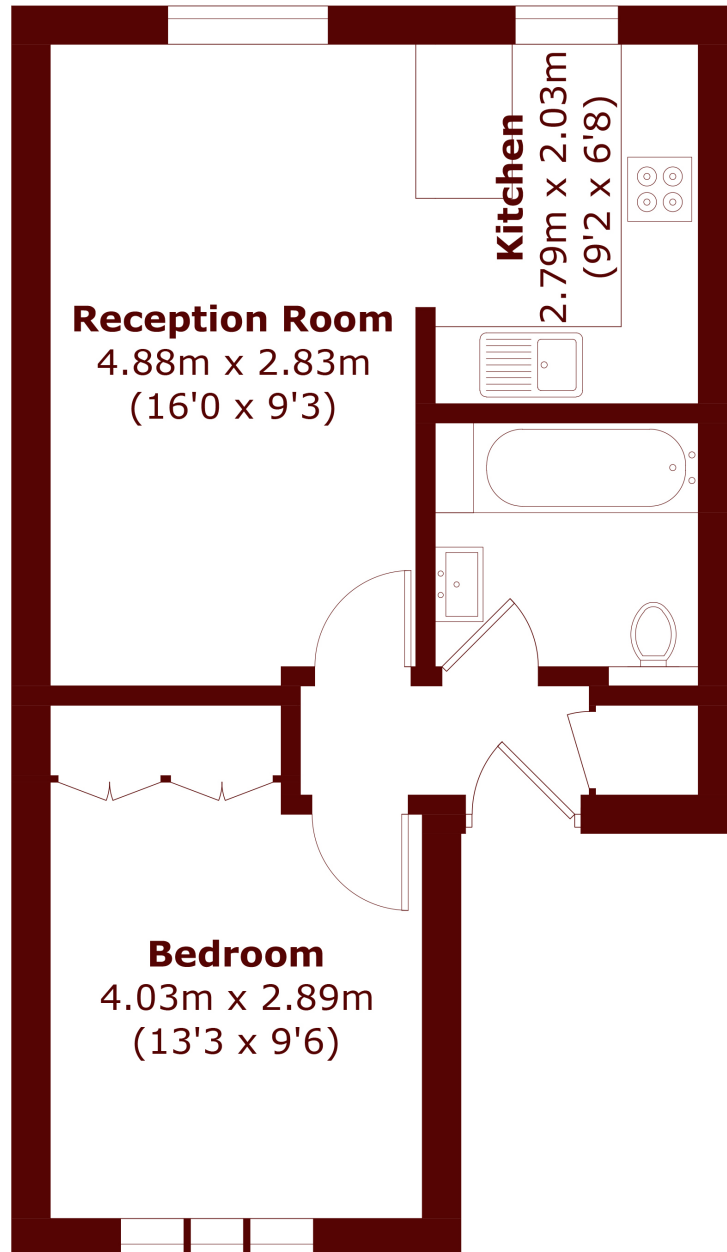

- One Bedroom
- First Floor
- High Ceilings
- Balcony
- Period Building
- Amazing location



Total area (approx.): 39.2 sq. m (421.9 sq. ft)

**Marsh & Parsons Notting Hill**

2-6 Kensington Park Road,  
London, W11 3BU  
020 7313 2890