



## Pembridge Gardens, W2

£923 per week (£3,999 pcm)



- First Floor
- Private Balcony
- High Ceilings
- Wooden Floors
- Excellent Condition
- Separate Storage Area

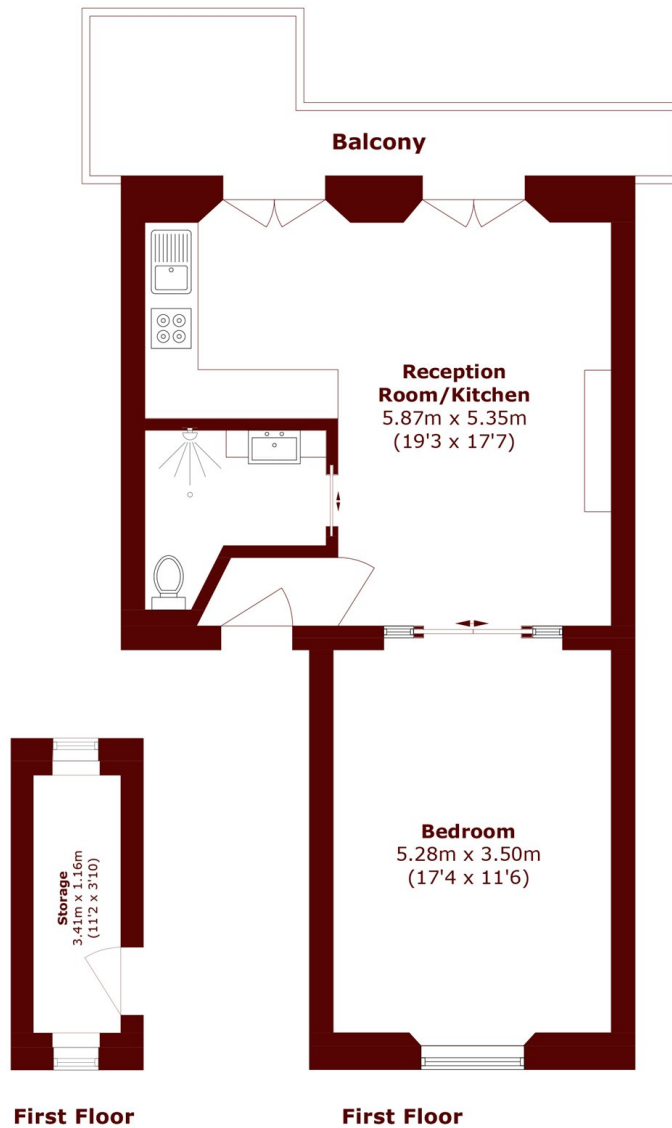

Total area (approx.): 50.0 sq. m (538.2 sq. ft)  
Balcony area (approx.): 9.1 sq. m (97.9 sq. ft)  
Storage area (approx.): 4.4 sq. m (47.3 sq. ft)

## Marsh & Parsons Notting Hill

2-6 Kensington Park Road,  
London, W11 3BU  
020 7313 2890