



Portobello Road, W11

£700 per week (£3,033.33 pcm)



- Modern Finish
- First Floor
- Double Bedroom
- Reception Room
- Kitchen
- Bathroom

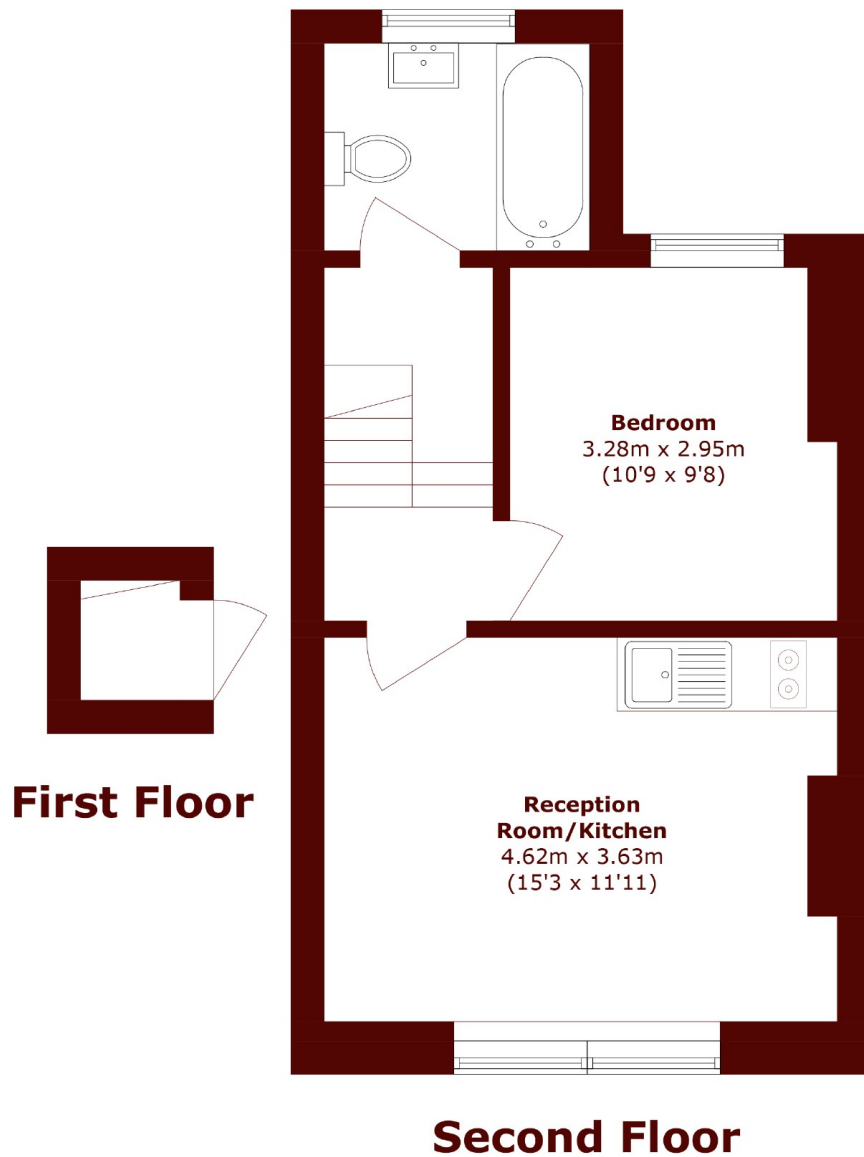

Total area (approx.): 38.0 sq. m (409.0 sq. ft)

Marsh & Parsons Notting Hill

2-6 Kensington Park Road,
London, W11 3BU
020 7313 2890