



## Hewer Street, W10

£475,000



- Newly Renovated
- Open Plan

- Two Bedrooms
- Quiet Cul-De-Sac

- 125-Year Lease
- Low Service Charge









## ABOUT THE PROPERTY

A stylish two-bedroom first floor flat with a modern open plan kitchen reception, contemporary bathroom and well-proportioned bedrooms, located in the heart of North Kensington.

The bright reception room features large sash windows, herringbone flooring and ample space for dining, seamlessly connected to a sleek kitchen finished with matte cabinetry and integrated appliances. Both bedrooms are well-proportioned doubles.

The principal bedroom is quietly positioned to the rear, while the second provides excellent flexibility equally suited as a comfortable double, home office or relaxed TV room. The apartment has been newly renovated throughout, offered with a new 125-year lease and a low annual service charge of £1,040.

Set on a quiet residential cul-de-sac, it offers an ideal home or investment opportunity close to Portobello Road and Ladbroke Grove station. The property has an EPC rating of C.

Hewer Street is a peaceful cul-de-sac located close to Ladbroke Grove and North Kensington. The area offers excellent transport links, boutique shops and popular cafés, with Portobello Road nearby.



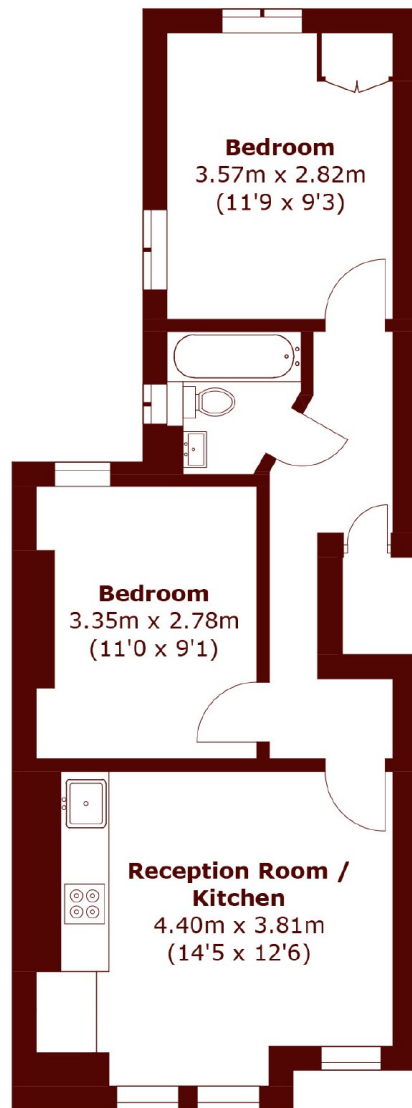

Total area (approx.): 45.6 sq. m (490.8 sq. ft)

**Marsh & Parsons North Kensington**

136 Lancaster Road, London,  
W11 1QU  
020 7313 8350