

nicholsons



10 Meadow Court

Victoria Road, Fleet, GU51 4DH

£1,250 Per month

A two bedroom first floor flat, with double glazed windows and radiator central heating, living room and separate kitchen, garage to the rear, situated within close proximity to Fleet high street. In the last year the property has been redecorated throughout and had new carpets fitted.

Viewing

Please contact our Fleet Office on 01252 628400 if you wish to arrange a viewing appointment for this property or require further information.



Floor Plan

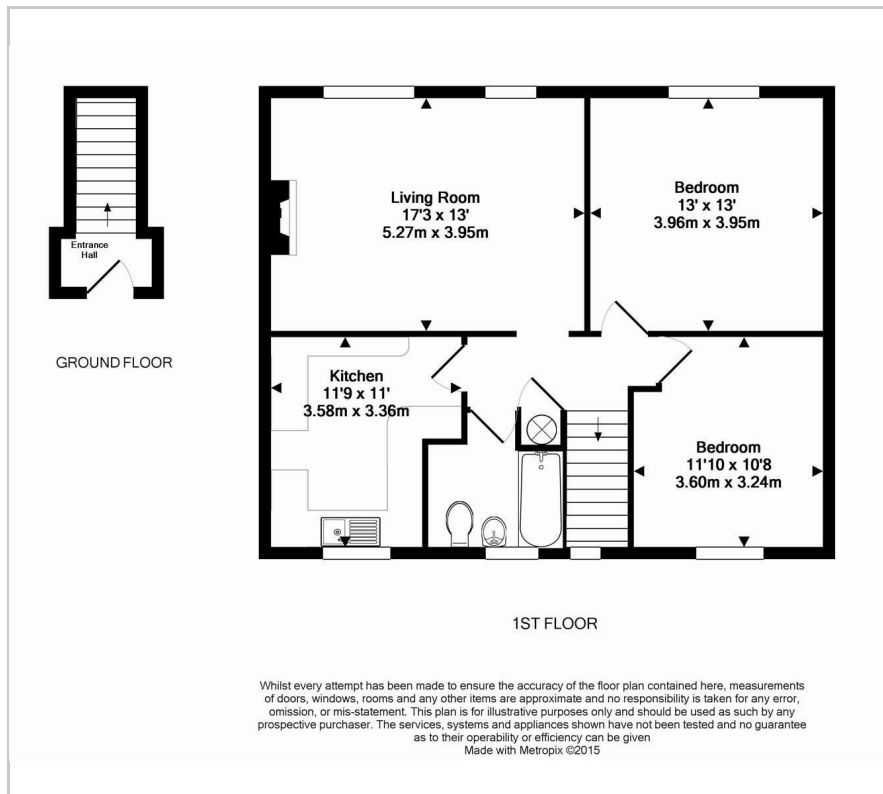

Area Map



Energy Efficiency Graph

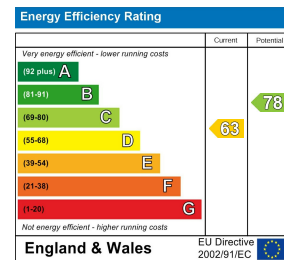

These particulars, whilst believed to be accurate are set out as a general outline only for guidance and do not constitute any part of an offer or contract. Intending purchasers should not rely on them as statements of representation of fact, but must satisfy themselves by inspection or otherwise as to their accuracy. No person in this firm's employment has the authority to make or give any representation or warranty in respect of the property.