



Joseph Powell Close, SW12

£699,999



- Almost 900 sq ft
- Freehold

- Potential to Improve
- Fantastic Location

- Priced to Sell
- No Chain

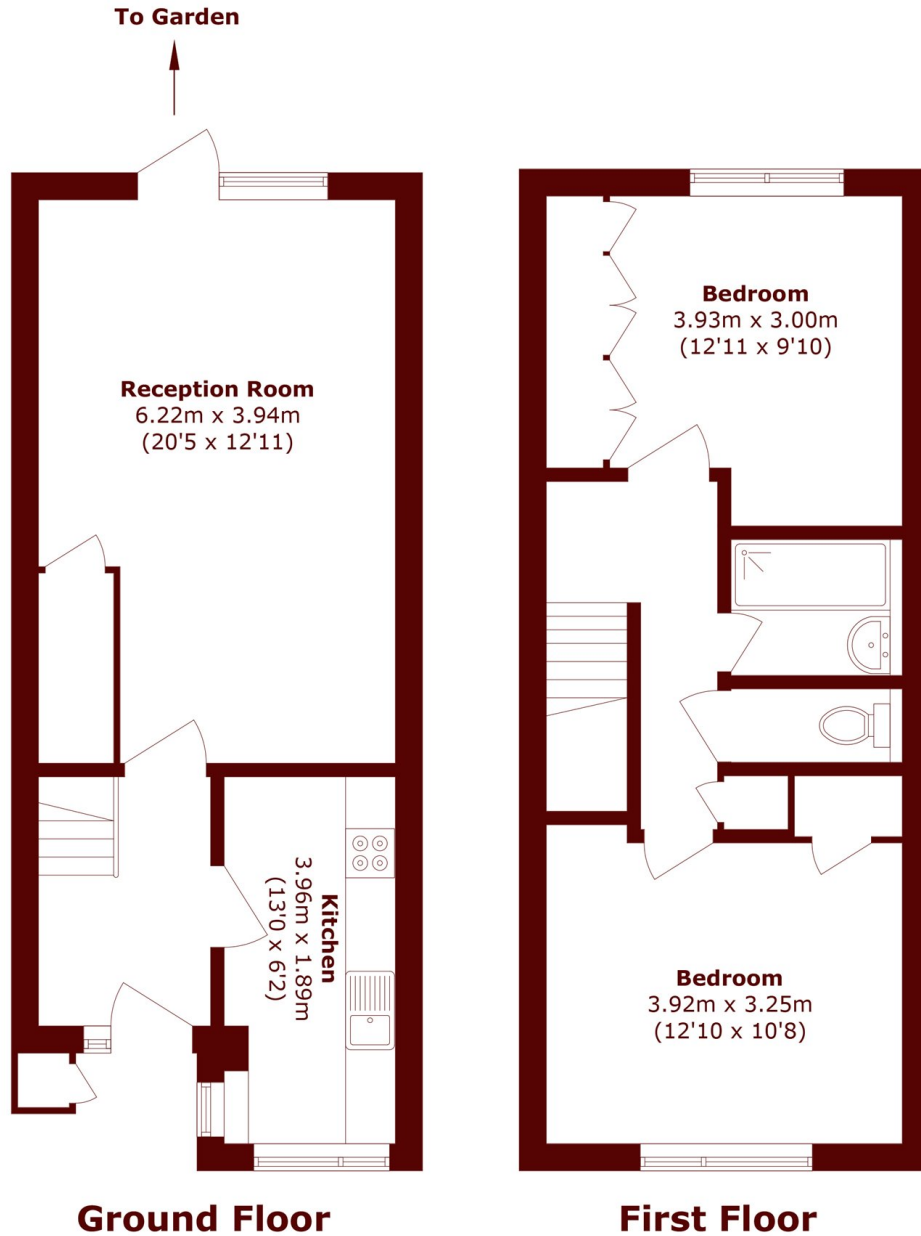

Total area (approx.): 79.4 sq. m (854.6 sq. ft)
External Cupboard: 0.3 sq. m (3.2 sq. ft)

Marsh & Parsons Balham & Clapham South

45 Balham Hill, London,
SW12 9DR
020 7228 9292