



## Colston Road, SW14

£500,000



- Three Bedrooms
- Split Level

- Off Street Parking
- Open Plan Living

- East Sheen
- Chain Free









## ABOUT THE PROPERTY

Offers in Excess of £500,000.

Marsh & Parsons are proud to present this immaculately presented three-bedroom split level flat in the heart of East Sheen.

The property comprises of three double bedrooms, a fully equipped modern open plan kitchen, living area and two bathrooms. The property has been tastefully modernised throughout and offers ample storage. Such as storage for bikes and eaves storage. The bedrooms are fitted with wardrobes and the bathrooms contain cabinets for further personal storage.

The property offers no onward chain.



Colston Road is located moments from the amenities of East Sheen which include a Waitrose, a variety of independent boutique shops, gastro pubs, restaurants, and coffee shops. The sellers personal favourite is Black Salt, an Indian cuisine. The property is a 10-minute bus ride into Richmond (on the tube and overground network) while from Mortlake station you can be in Clapham Junction in 12 minutes, Vauxhall in 19 minutes and London Waterloo in 23 minutes.



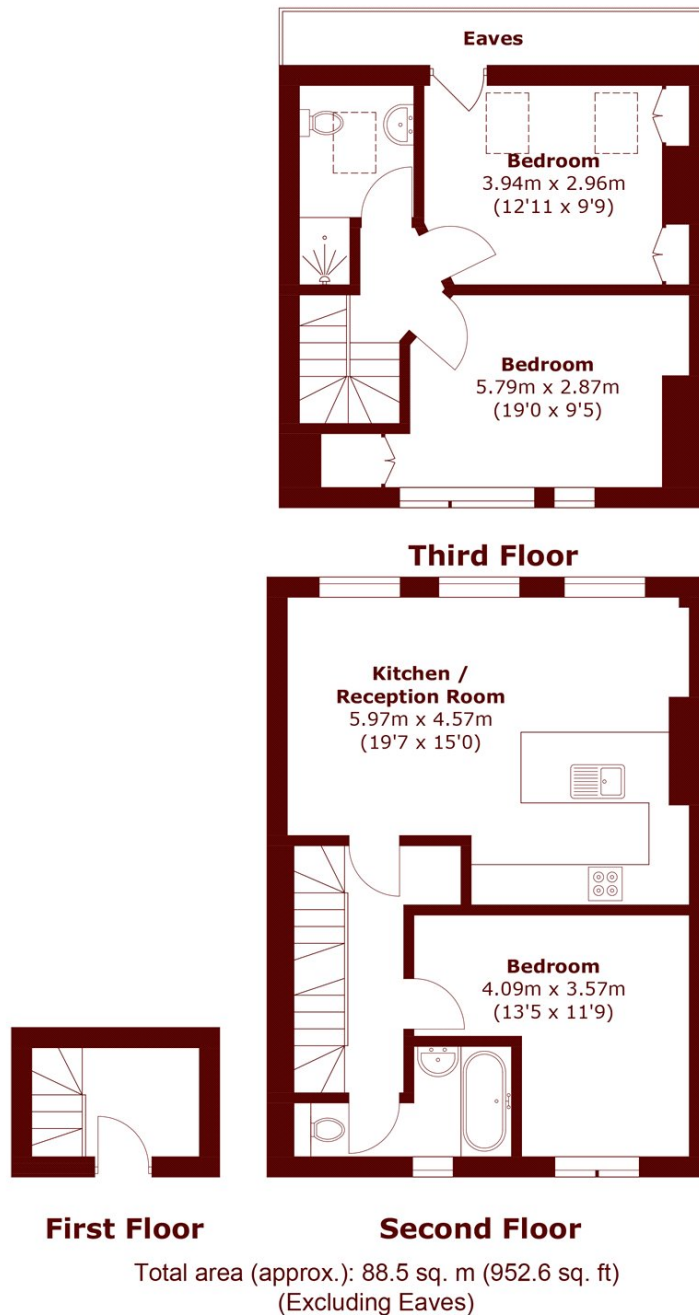

**Marsh & Parsons Barnes**  
73-75 Church Road, London,  
SW13 9HH  
020 8563 8333

We aim to make our particulars both accurate and reliable. However, they are not guaranteed; nor do they form part of an offer or contract. If you require clarification on any points then please contact us, especially if you're traveling some distance to view. Please note that appliances and heating systems have not been tested and therefore no warranties can be given as to their good working order.