



Eastfields Avenue, SW18

£3,000 pcm



- Two Bedrooms
- Two Bathrooms

- Beautiful Condition
- Balcony

- Gym And Pool Access
- Underground Parking

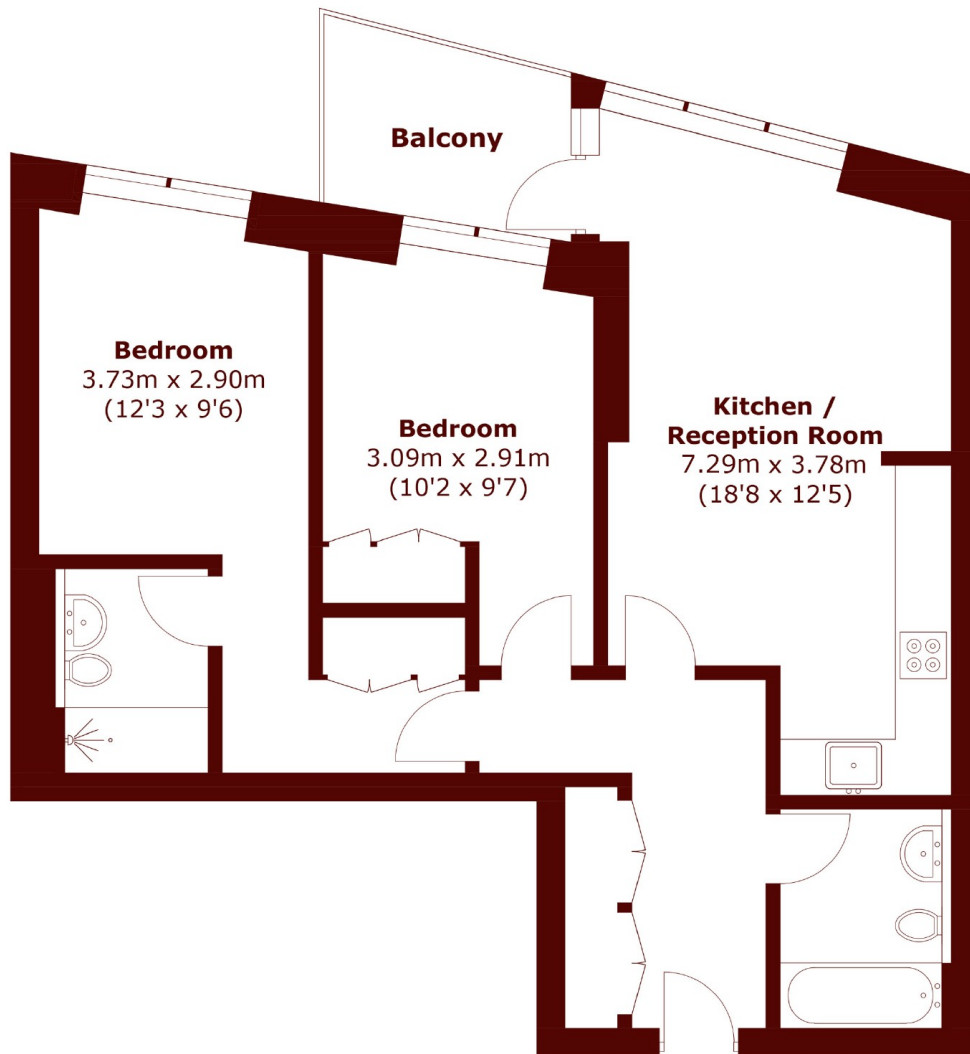

Total area (approx.): 70.95sq.m (763.2sq.ft)
Balcony: 5.00sq.m (53.8sq.ft)

Marsh & Parsons Barnes

73-75 Church Road, London,
SW13 9HH
020 8563 8333