



## Doyle House, SW13

£700,000



- Two Double Bedrooms
- Ground Floor
- Immaculately Presented
- Barnes Waterside
- Chain Free
- Private Parking Space









## ABOUT THE PROPERTY

Marsh and Parsons are pleased to present this beautifully refurbished two-bedroom ground-floor apartment in Doyle House. Ideally located near the River Thames and a short walk from Hammersmith Underground, the property features a modern eat-in kitchen with integrated appliances, a spacious living area with bay window and garden views, two double bedrooms with built-in storage (one with an en-suite), and a separate family bathroom.

The flat has been refurbished to a high standard and has a luxurious feel. The property also benefits from a private parking space. This property is offered to the market 'chain free'.



There are some excellent schools in the area, including renowned St Paul's Boys & Juniors, The Harroddian and The Swedish School. Lowther Primary School is also nearby. Hammersmith Station is the closest transport hub, with four underground lines (Hammersmith Bridge currently open to foot traffic). Nearby mainline stations, for regular routes into London Waterloo and out of London, are Barnes and Barnes Bridge Station.



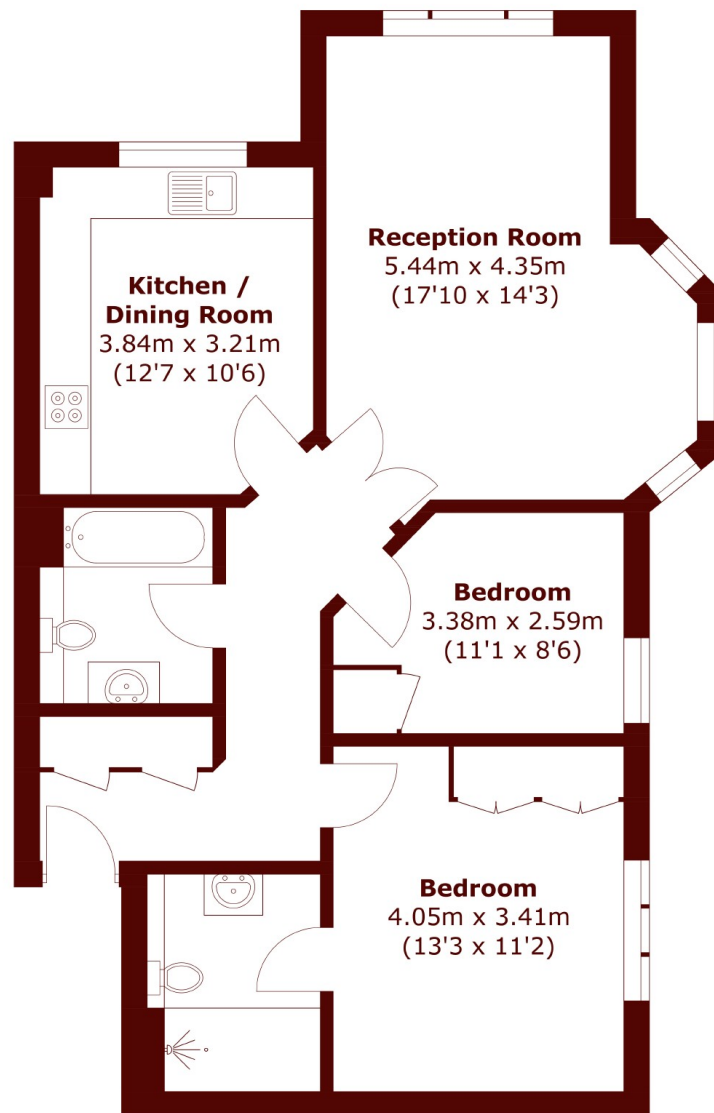

Total area (approx.): 78.0 sq. m (839.6 sq. ft)

**Marsh & Parsons Barnes**  
73-75 Church Road, London,  
SW13 9HH  
020 8563 8333

We aim to make our particulars both accurate and reliable. However, they are not guaranteed; nor do they form part of an offer or contract. If you require clarification on any points then please contact us, especially if you're traveling some distance to view. Please note that appliances and heating systems have not been tested and therefore no warranties can be given as to their good working order.